



# minipack Vision con nastro

## Catalogo ricambi

( Valido dalla matricola nr. 101 del 09.1999 fino alla matr. nr. 242 del 11.2001 )

## Spare parts catalogue

( Valid from serial number 101 dated 09.1999 at to 242 dated 11.2001 )

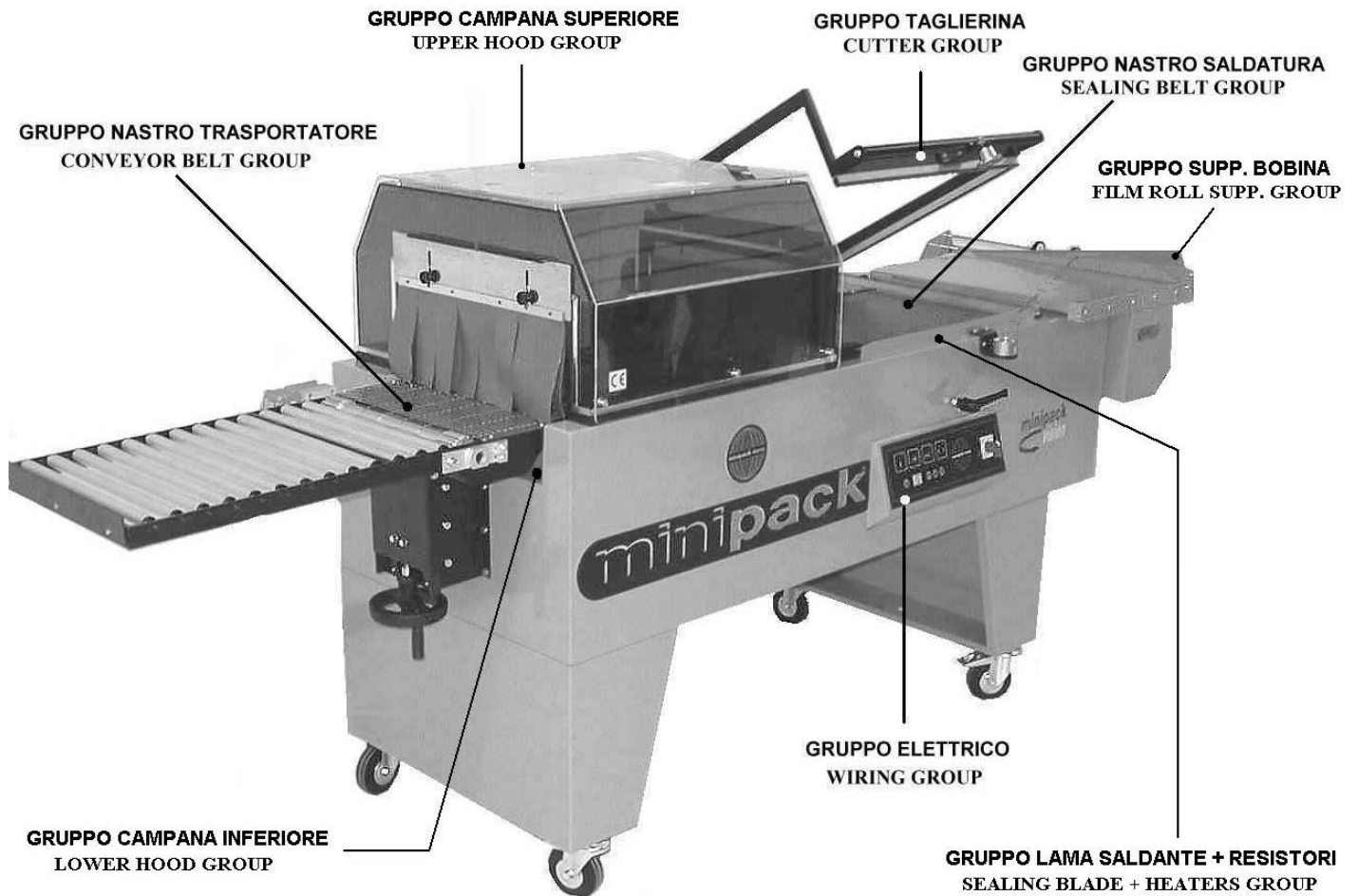

Consultare attentamente questo libretto prima di ordinare pezzi di ricambio  
Carefully read this booklet before ordering spare parts



DOC. N. FM112029  
REV. 0  
Ed: 10.2001

# УПАКОВОЧНОЕ ОБОРУДОВАНИЕ



ПРОИЗВОДСТВО И ПОСТАВКА  
СЕРВИСНЫЙ РЕМОНТ  
ЗАПАСНЫЕ ЧАСТИ  
РАСХОДНЫЕ МАТЕРИАЛЫ

Диагностика, ремонт, сервисное обслуживание.

Запасные части и расходный материал: резина, тефлоновая лента, термонож (лезвие), гель для смазки.

Плѐнка термоусадочная полиолефиновая.

Система «Trade-In» – замена Вашего оборудования на новое и более производительное.



*На фото: запайщик Magnetic FL900 + туннель Magnetic T100*

ООО «АРДсистемы»

(495) 231-21-00

(812) 363-20-22

info@ardsystems.ru

[www.filmtrade.ru](http://www.filmtrade.ru)

[www.ardsystems.ru](http://www.ardsystems.ru)

**INDICE GRUPPI DI RICAMBIO / INDEX OF SPARE PARTS GROUPS**

<b>TAVOLA NR. SCHEME N.</b>	<b>DESCRIZIONE DESCRIPTION</b>	<b>PAGINA PAGE</b>
<b>1</b>	GRUPPO LAMA SALDANTE + RESISTORI SEALING BLADE + HEATERS GROUP	<b>1</b>
<b>2</b>	GRUPPO TAGLIERINA CUTTER GROUP	<b>2</b>
<b>3</b>	GRUPPO CAMPANA INFERIORE LOWER HOOD GROUP	<b>3</b>
<b>4</b>	GRUPPO CAMPANA SUPERIORE UPPER HOOD GROUP	<b>4</b>
<b>5</b>	GRUPPO SUPPORTO BOBINA FILM ROLL SUPPORT GROUP	<b>5</b>
<b>6</b>	GRUPPO NASTRO TRASPORTATORE CONVEYOR BELT GROUP	<b>6</b>
<b>7</b>	GRUPPO NASTRO SALDATURA SEALING BELT GROUP	<b>7</b>
<b>8</b>	GRUPPO AVVOLGITORE FILM (optional) FILM WINDER GROUP (optional)	<b>8</b>
<b>9</b>	GRUPPO ELETTRICO WIRING GROUP	<b>9</b>
	SCHEMA ELETTRICO WIRING DIAGRAM	<b>10</b>

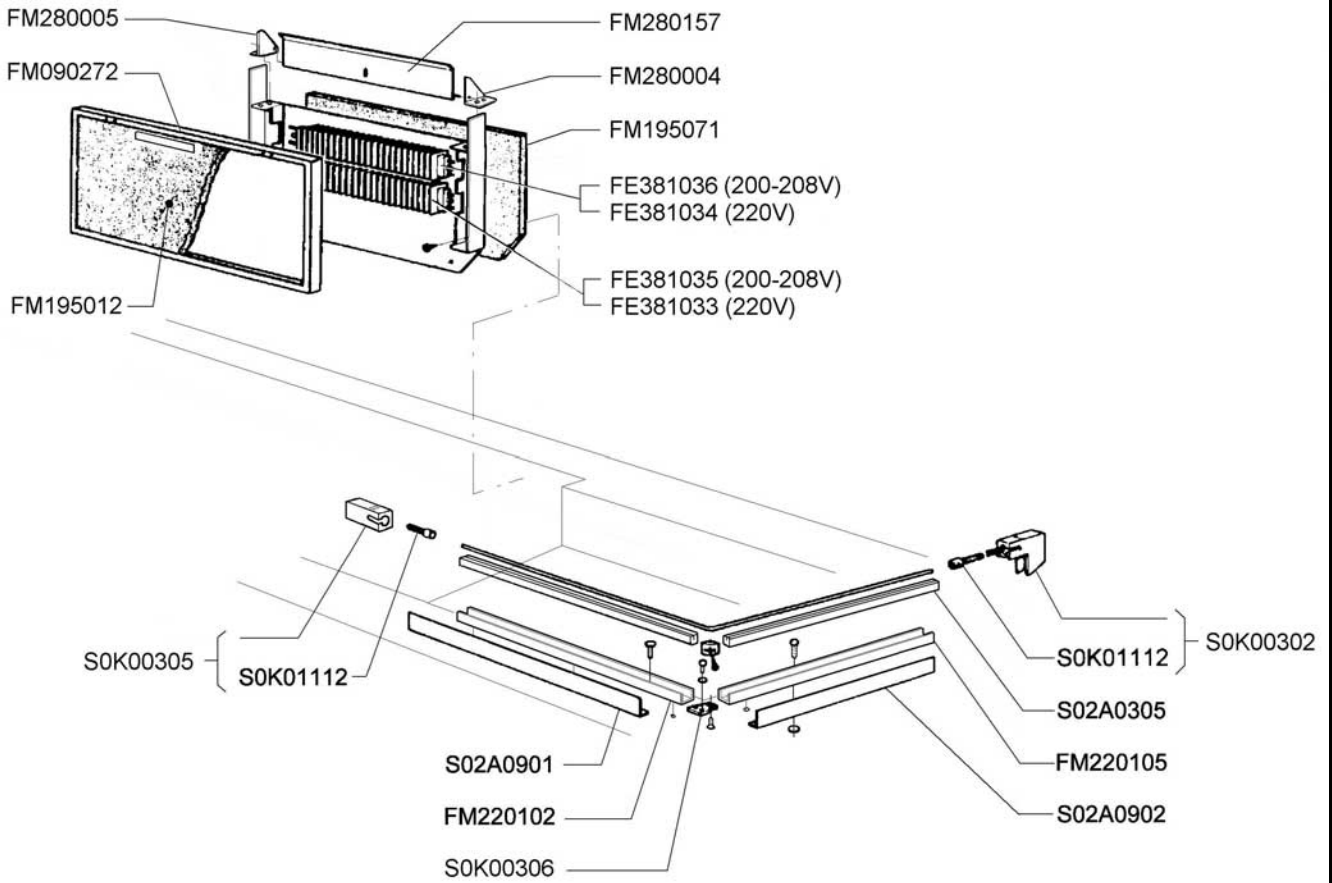

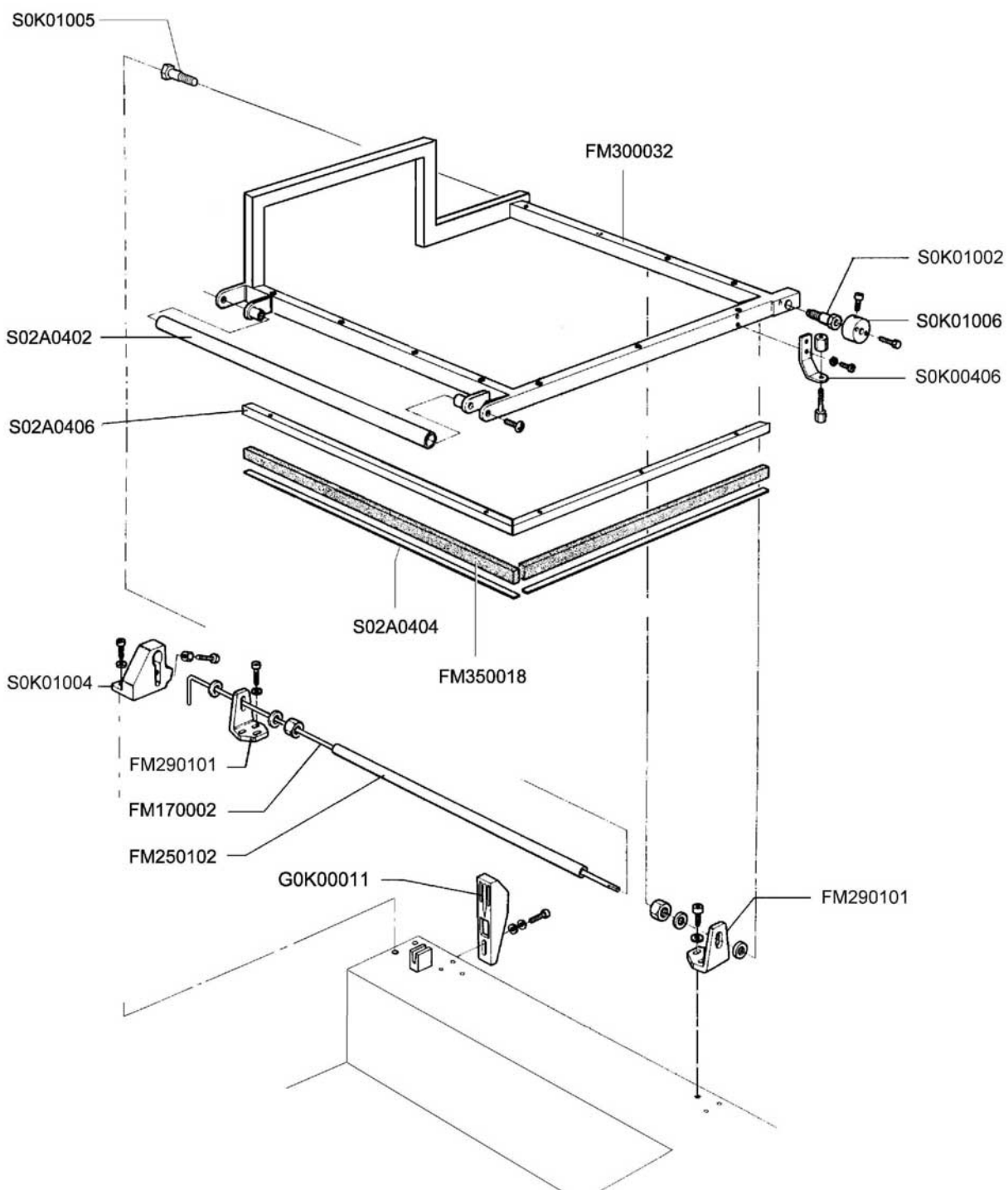

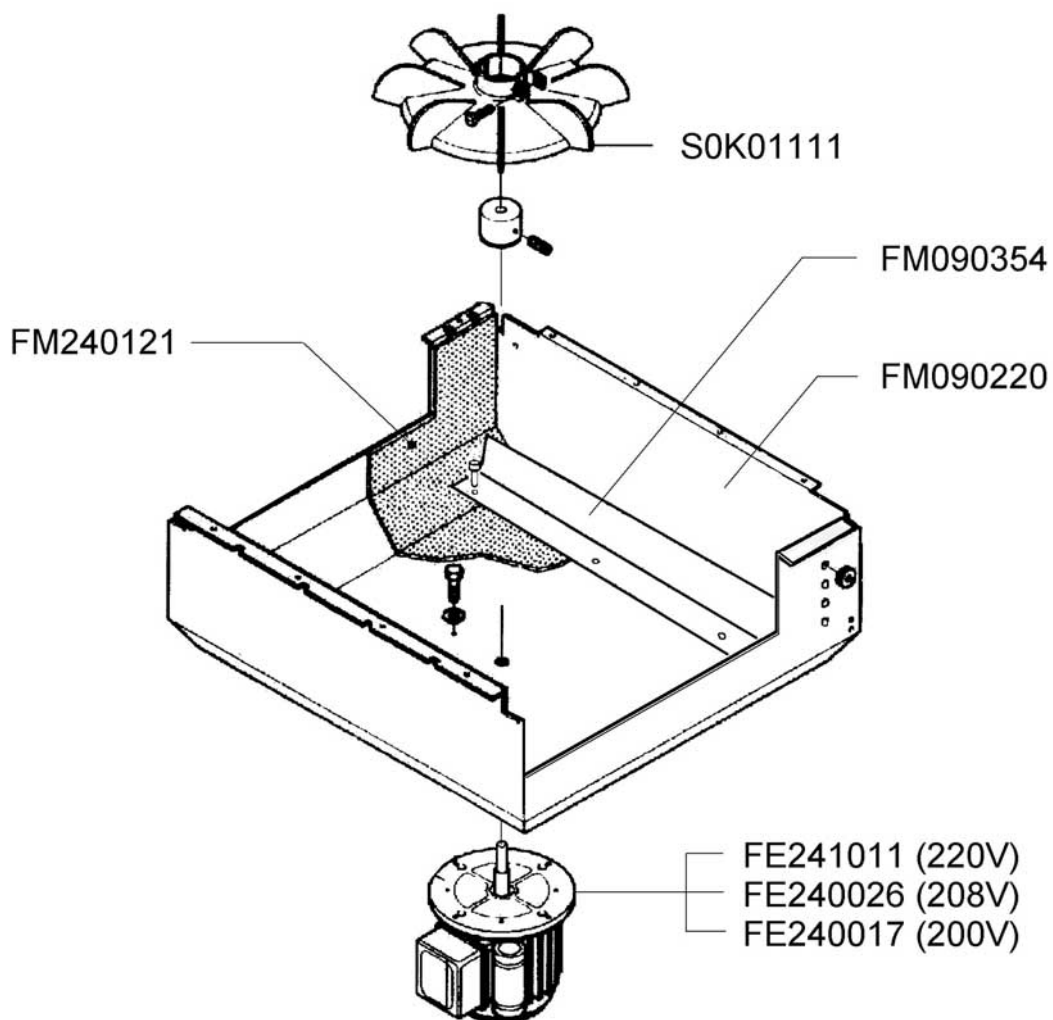

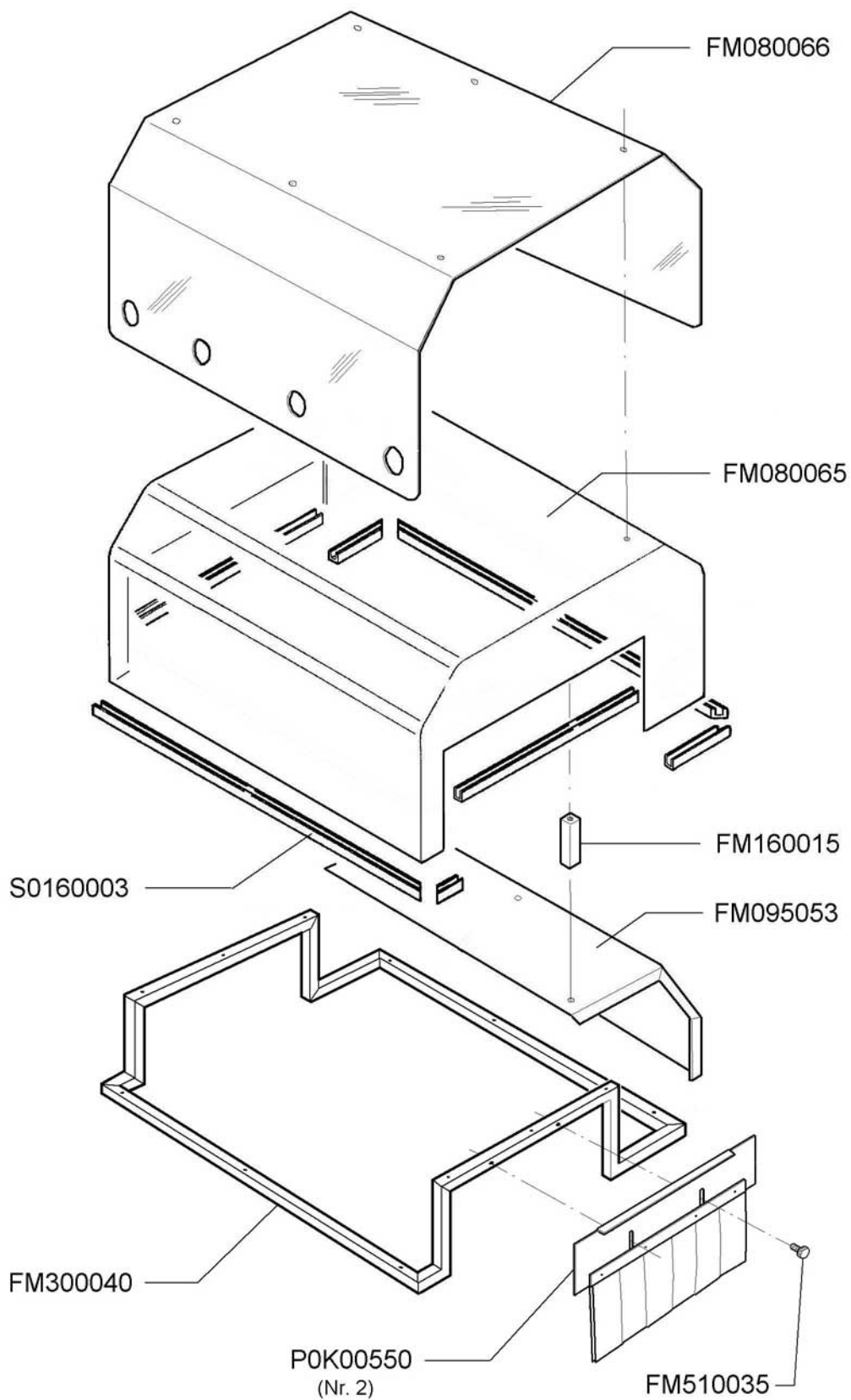

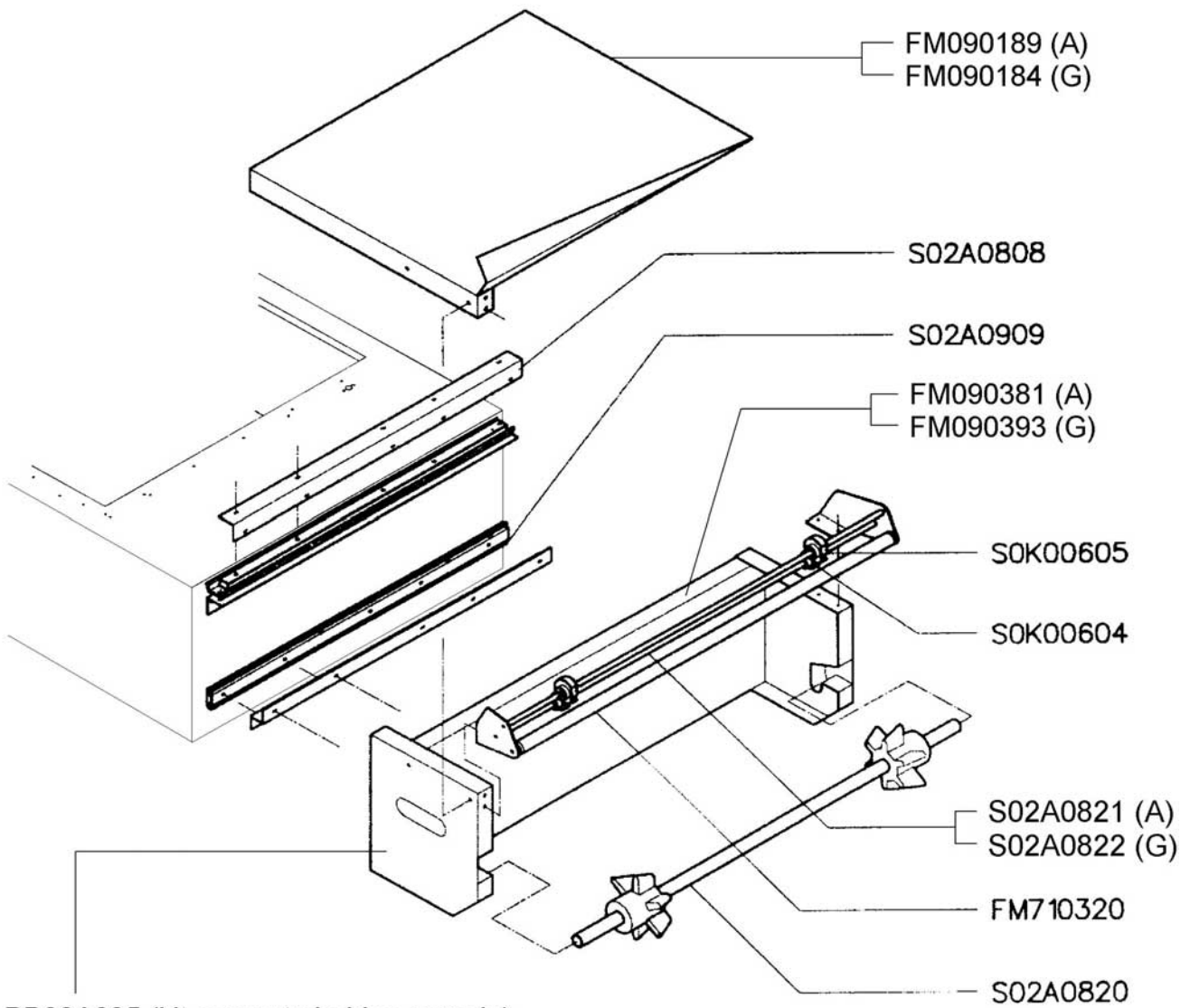

PB02A035 (kit supporto bobina arancio)  
(orange film roll support kit)  
PB02B035 (kit supporto bobina grigio)  
(grey film roll support kit)



GRUPPO NASTRO TRASPORTATORE  
CONVEYOR BELT GROUP

TAVOLA 6  
SCHEME 6

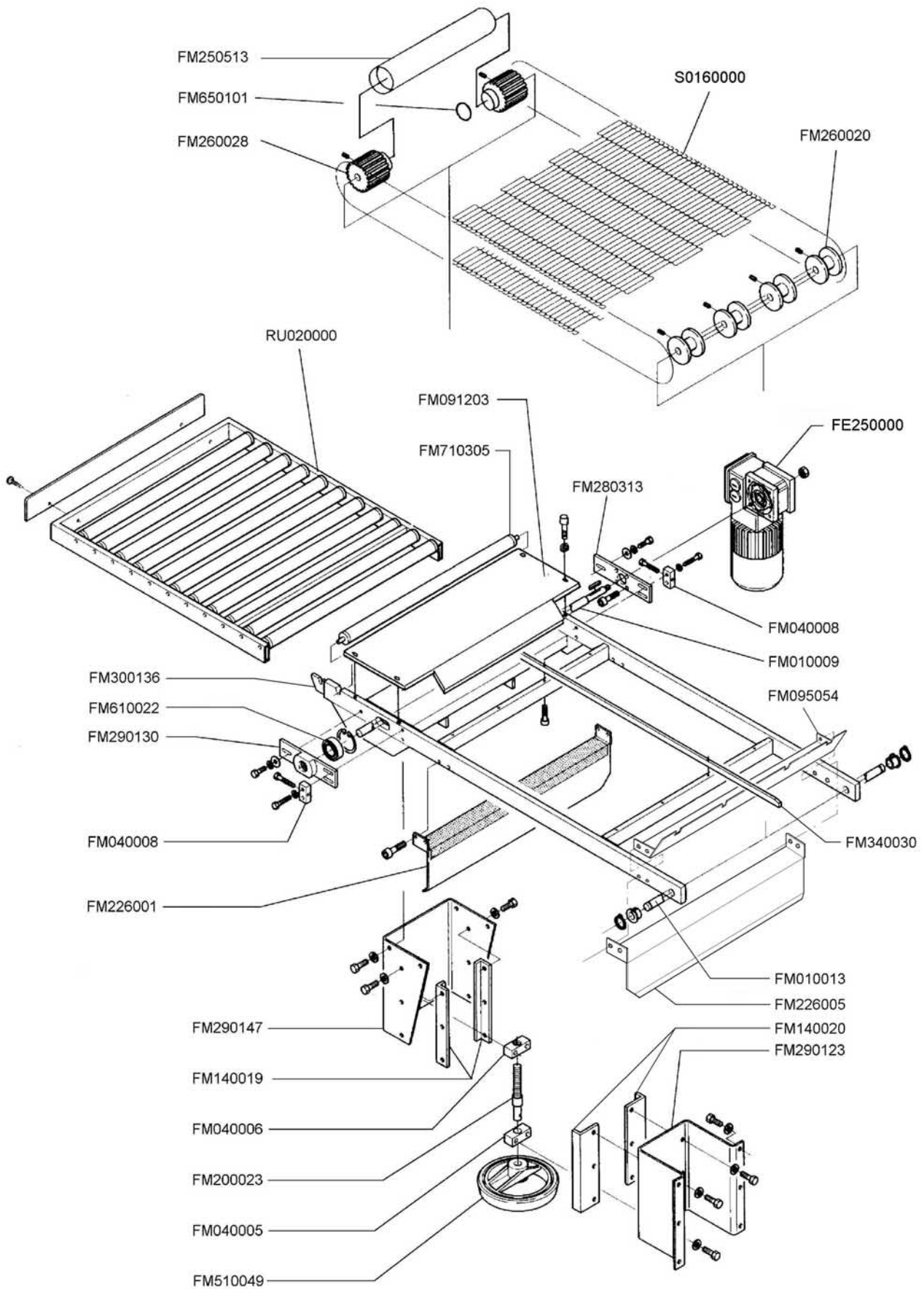

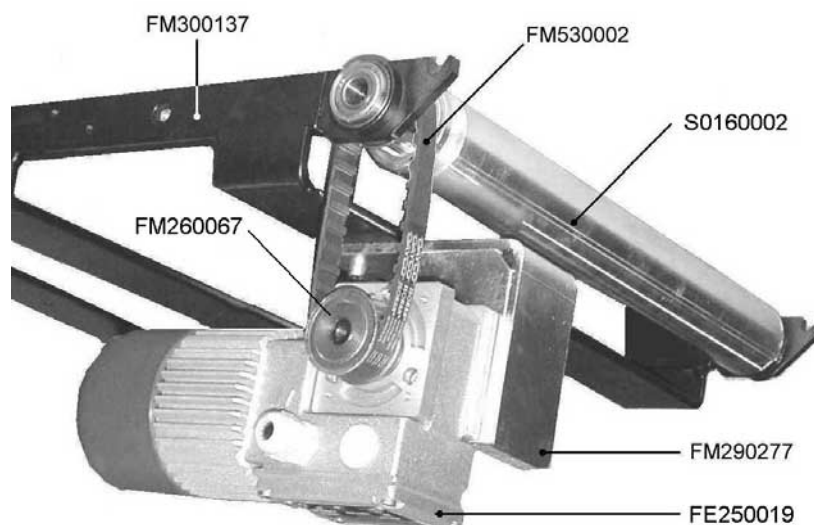

Lato ingresso / Inlet side

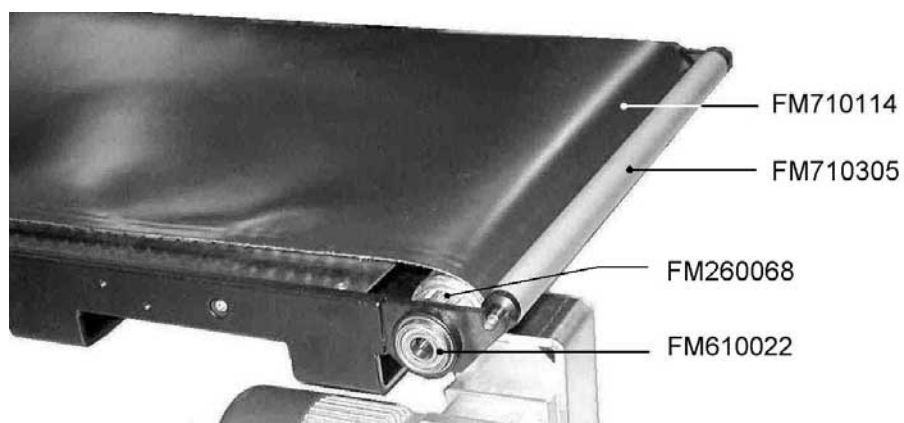

Lato ingresso / Inlet side

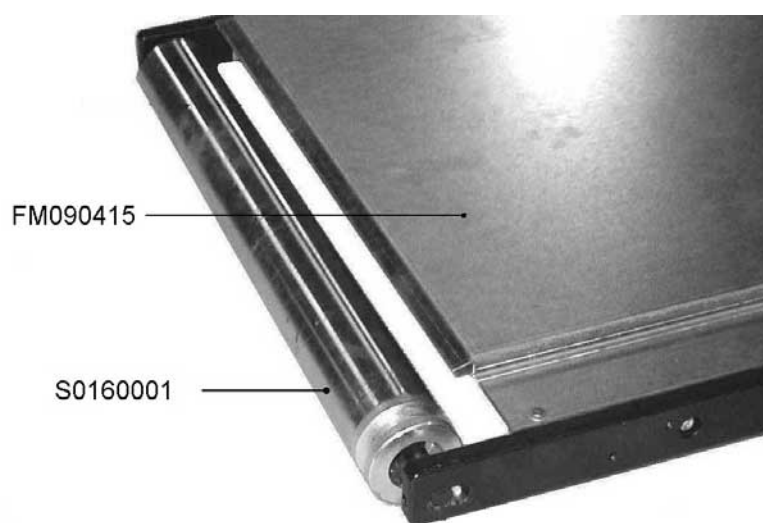

Lato uscita / Outlet side

**GRUPPO AVVOLGITORE FILM (optional)  
FILM WINDER GROUP (optional))**

**TAVOLA 8  
SCHEME 8**

AV160000

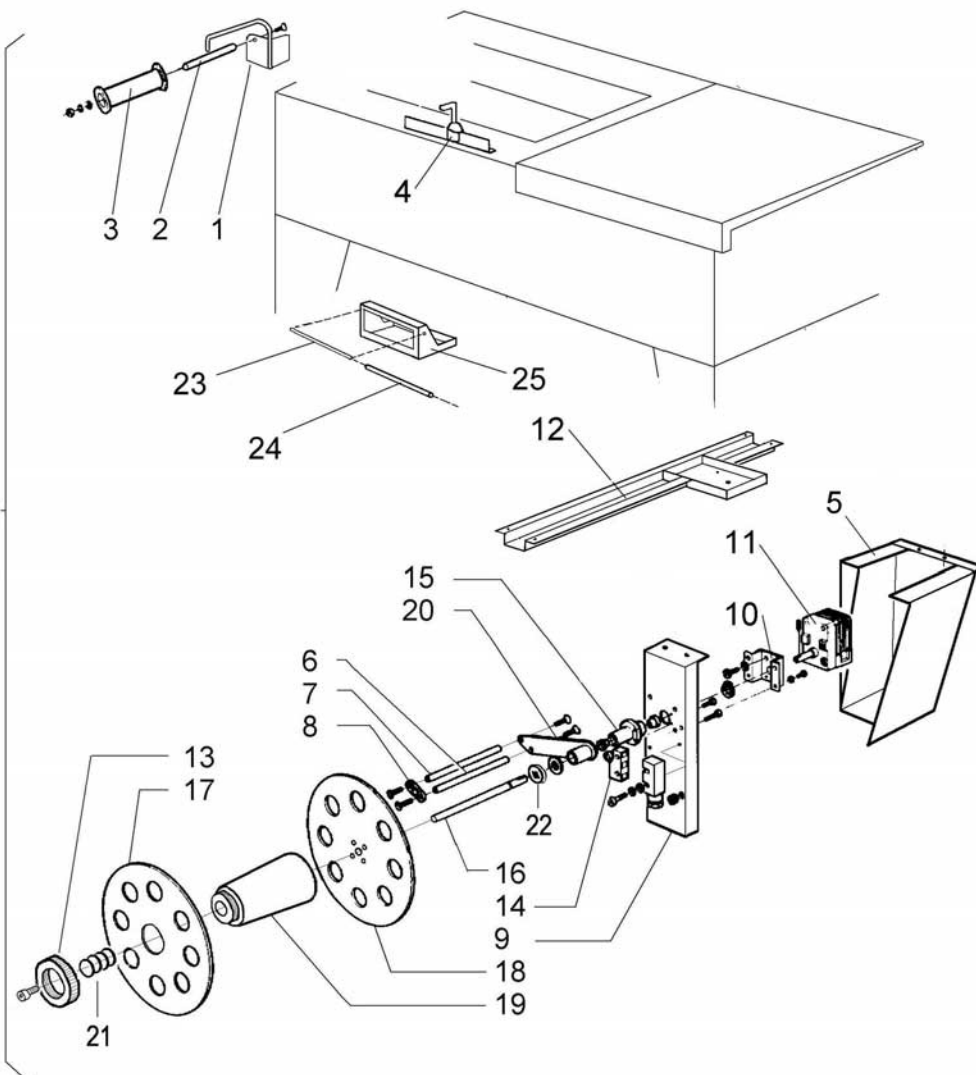

POS. POS.	CODICI PARTICOLARI ITEMS CODE	DENOMINAZIONI PARTICOLARI ITEMS DESCRIPTION	Q.tà Q.ty
1	FM290025	Supporto rinvio film / Film transmission support	1
2	FM200069	Perno per rullo di rinvio / Transmission roller pin	1
3	FM250049	Rullo rinvio / Transmission roller	1
4	S0K00407	Gruppo guida a piolo per film / Film roll guide group	1
5	FM095136	Carter motoriduttore / Gearmotor carter	1
6	FM030063	Asta per leva avvolgitore / Winder lever rod	2
7	FM250074	Rullo per avvolgitore / Winder roller	1
8	FM280326	Piastrina di collegamento / Connecting plate	1
9	FM290173	Supporto avvolgitore / Winder support	1
10	FM290107	Supporto motoriduttore / Gearmotor support	1
11	FE250016	Motoriduttore V220 / 220V gearmotor	1
12	FM290023	Traversa supporto avvolgitore / Winder support frame	1
13	FM160104	Ghiera di bloccaggio / Blocking ring nut	1
14	FE220105	Microinterruttore/ Microswitch	1
15	FM290172	Supporto leva tensore / Tightener lever support	1
16	FM010041	Albero per avvolgitore / Winder shaft	1
17	FM120022	Flangia mobile / Mobile flange	1
18	FM120015	Flangia fissa / Fix flange	1
19	FM250121	Mozzo / Hub	1
20	FM060027	Leva per avvolgitore / Winder lever	1
21	FM160086	Molla / Spring	1
22	FM160111	Rondella strisciamento avvolgitore / Winder Washer	1
23	FM200060	Perno per rullo di rinvio / Transmission roller pin	1
24	FM250038	Rullo rinvio / Transmission roller	1
25	FM290024	Supporto rinvio film / Film transmission support	1

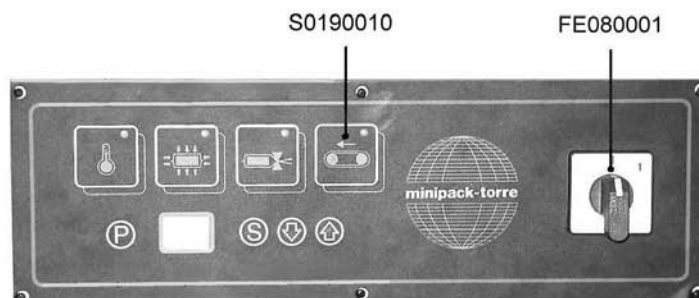

S0190010:  
FM110135 membrana / adhesive label  
SM190037 pannello / panel  
FE120230 scheda comando / electronic board

pannello comandi / control panel

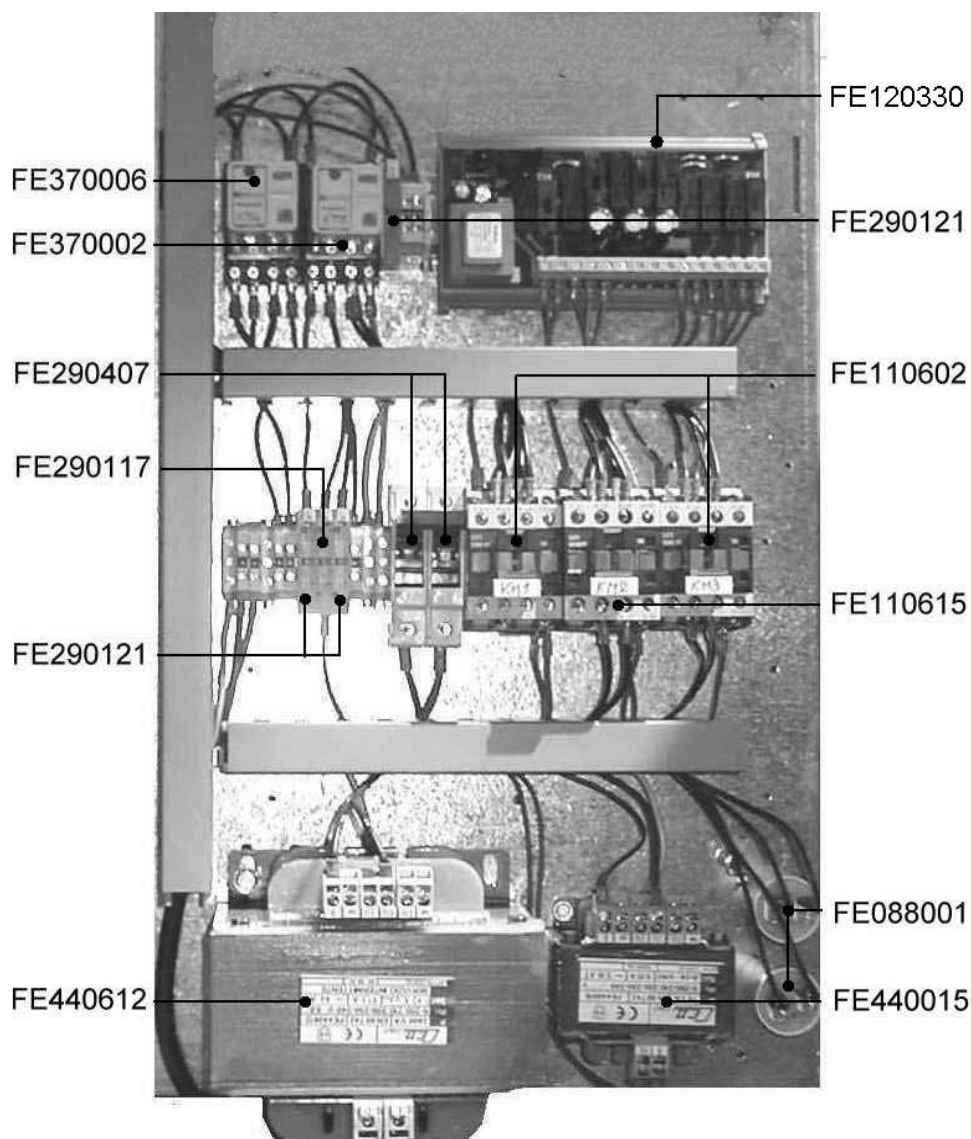

Cassetto elettrico / Wiring box

# SCHEMA ELETTRICO WIRING DIAGRAM

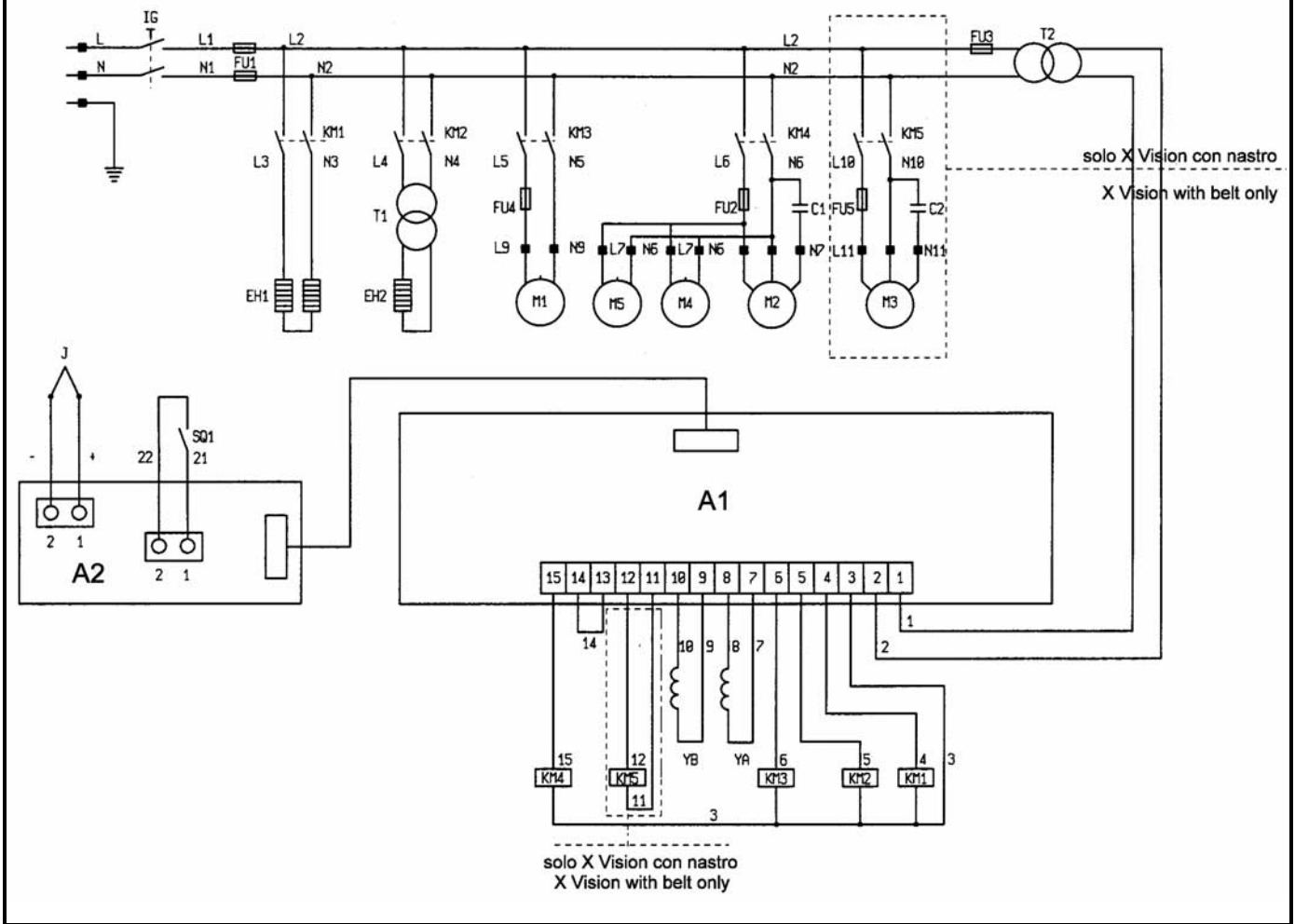

IG	Interruttore generale	A2	Scheda comando
FU1	Fusibile generale 20A	KM1	Contattore resistenze
FU2	Fusibile nastro forno T2A	KM2	Contattore lama saldatura
FU3	Fusibile trasformatore ausiliario T1A	KM3	Contattore motore ventola
FU4	Fusibile motore ventola T2A	KM4	Contattore motore nastro forno
FU5	Fusibile motore nastro saldatura T2A	KM5	Contattore motore nastro saldatura
EH1	Resistenza forno	M1	Motore ventola retrazione
EH2	Resistenza lama saldatura	M2	Motore nastro forno
T1	Trasformatore saldatura	M3	Motore nastro saldatura
T2	Trasformatore ausiliario	M4	Motore ventilatore x motore retrazione
J	Termocoppia	M5	Motore ventilatore raffreddamento forno
SQ1	Micro start	YA	Elettromagnete retrazione
A1	Modulo potenza	YB	Elettromagnete saldatura
IG	Main switch	A2	Control board
FU1	General fuse 16A	KM1	Heaters contactor
FU2	Oven tunnel fuse T2A	KM2	Sealing blade contactor
FU3	Auxiliary transformer fuse T1A	KM3	Fan motor contactor
FU4	Fan motor fuse T2A	KM4	Oven belt motor contactor
FU5	Motor fuse for sealing belt T1A	KM5	Motor contactor for sealing belt
EH1	Oven heater	M1	Shrinking fan motor
EH2	Sealing blade heater	M2	Oven belt motor
T1	Cutting transformer	M3	Sealing belt motor
T2	Auxiliary transformer	M4	Fan motor of oven cooling
J	Thermocouple	M5	Fan motor of shrinking motor
SQ1	Machine cycle limit switch	YA	Shrinking magnet
A1	Electronic control board	YB	Sealing magnet



**minipack-torre S.p.A.**  
Via Provinciale, 54 - 24044 DALMINE (BG) - ITALY  
Tel. (035) 563525 (4 linee r.a.)  
Fax (035) 564945