



**Minipack-torre S.p.A.**  
Via Provinciale, 54 - 24044 Dalmine (BG) - Italy  
Tel. (035) 563525 – Fax (035) 564945  
E-mail: info@minipack-torre.it  
<http://www.minipack-torre.it>



# minipack Vision Restyling

**Catalogo ricambi**  
( Valido dalla matricola nr. 243 del 02.2002 )  
**Spare parts catalogue**  
( Valid from serial number 243 dated 02.2002 )

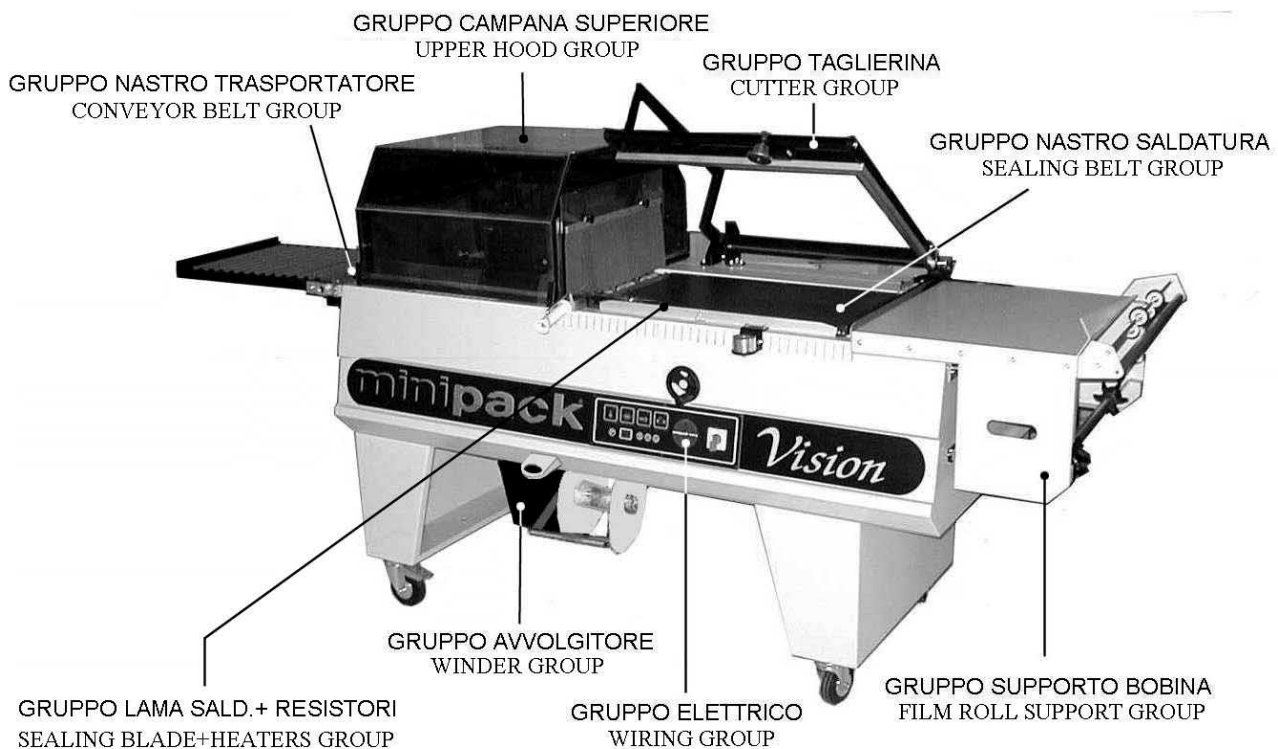

CONSULTARE ATTENTAMENTE QUESTO CATALOGO PRIMA DI ORDINARE PEZZI DI RICAMBIO  
CAREFULLY READ THIS CATALOGUE BEFORE ORDERING ANY SPARE PART



DOC. N. FM112029  
REV. 02  
Ed: 10.2006

# УПАКОВОЧНОЕ ОБОРУДОВАНИЕ



ПРОИЗВОДСТВО И ПОСТАВКА  
СЕРВИСНЫЙ РЕМОНТ  
ЗАПАСНЫЕ ЧАСТИ  
РАСХОДНЫЕ МАТЕРИАЛЫ

Диагностика, ремонт, сервисное обслуживание.

Запасные части и расходный материал: резина, тефлоновая лента, термонож (лезвие), гель для смазки.

Плѐнка термоусадочная полиолефиновая.

Система «Trade-In» – замена Вашего оборудования на новое и более производительное.



*На фото: запайщик Magnetic FL900 + туннель Magnetic T100*

ООО «АРДсистемы»

(495) 231-21-00

(812) 363-20-22

info@ardsystems.ru

[www.filmtrade.ru](http://www.filmtrade.ru)

[www.ardsystems.ru](http://www.ardsystems.ru)

# INDICE INDEX

<b>TAVOLA NR. SCHEME N.</b>	<b>DESCRIZIONE DESCRIPTION</b>	<b>PAGINA PAGE</b>
<b>1</b>	GRUPPO LAMA SALDANTE + RESISTORI SEALING BLADE + HEATERS GROUP	<b>1</b>
<b>2</b>	GRUPPO TAGLIERINA CUTTER GROUP	<b>2</b>
<b>3</b>	GRUPPO CAMPANA INFERIORE LOWER HOOD GROUP	<b>3</b>
<b>4</b>	GRUPPO CAMPANA SUPERIORE UPPER HOOD GROUP	<b>4</b>
<b>5</b>	GRUPPO SUPPORTO BOBINA FILM ROLL SUPPORT GROUP	<b>5</b>
<b>6</b>	GRUPPO NASTRO TRASPORTATORE CONVEYOR BELT GROUP	<b>6</b>
<b>7</b>	GRUPPO NASTRO SALDATURA SEALING BELT GROUP	<b>7</b>
<b>8</b>	GRUPPO AVVOLGITORE FILM FILM WINDER GROUP	<b>8</b>
<b>9</b>	PANNELLO COMANDI CONTROL PANEL	<b>9</b>
<b>10.1</b>	CASSETTO ELETTRICO TRIFASE THREEPHASE WIRING BOX	<b>10</b>
<b>10.2</b>	CASSETTO ELETTRICO MONOFASE MONOPHASE WIRING BOX	<b>11</b>
<b>11.1</b>	SCHEMA ELETTRICO TRIFASE THREEPHASE WIRING DIAGRAM	<b>12</b>
<b>11.2</b>	SCHEMA ELETTRICO MONOFASE MONOPHASE WIRING DIAGRAM	<b>13</b>

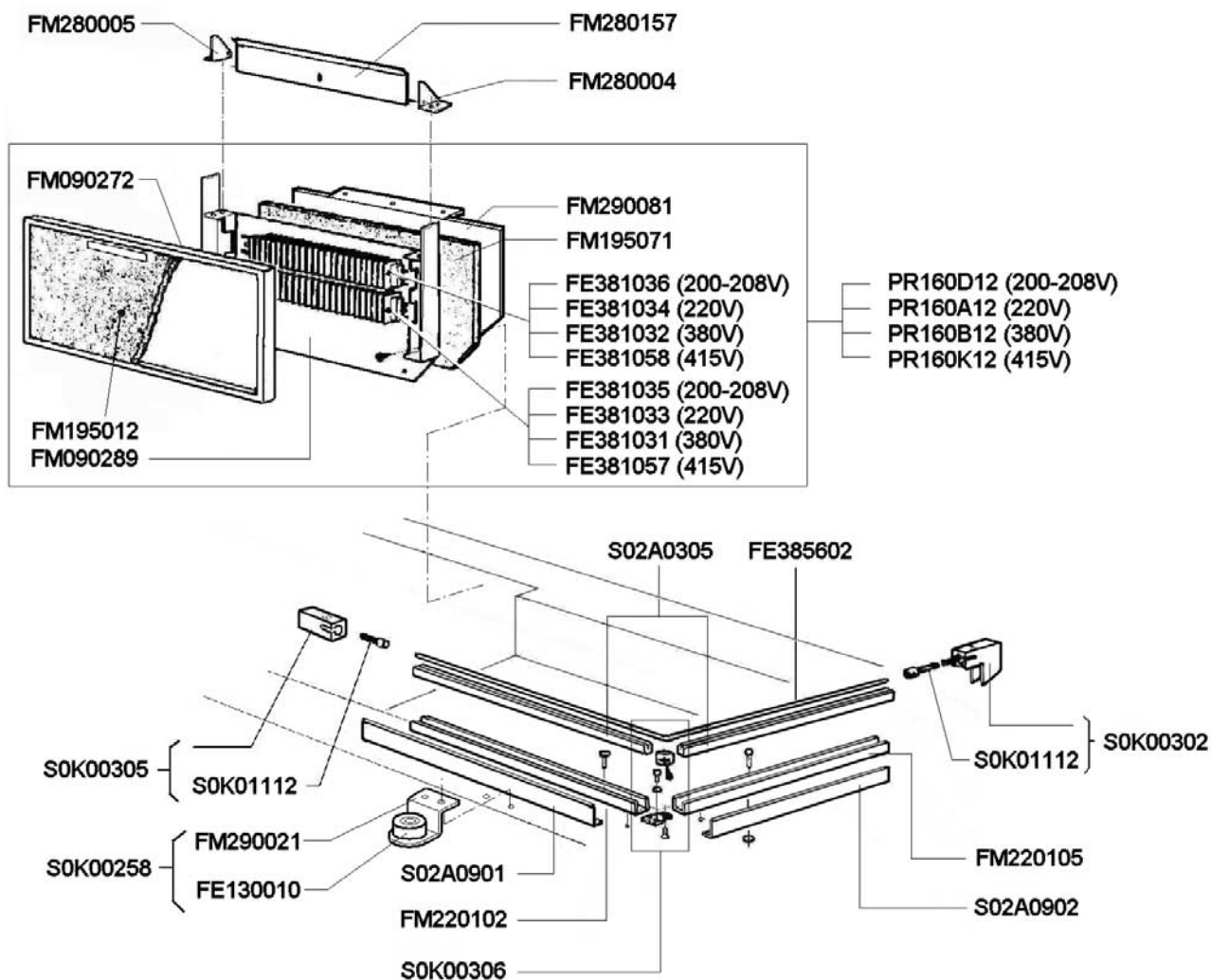

GRUPPO TAGLIERINA  
CUTTER GROUP

TAVOLA 2  
SCHEME 2

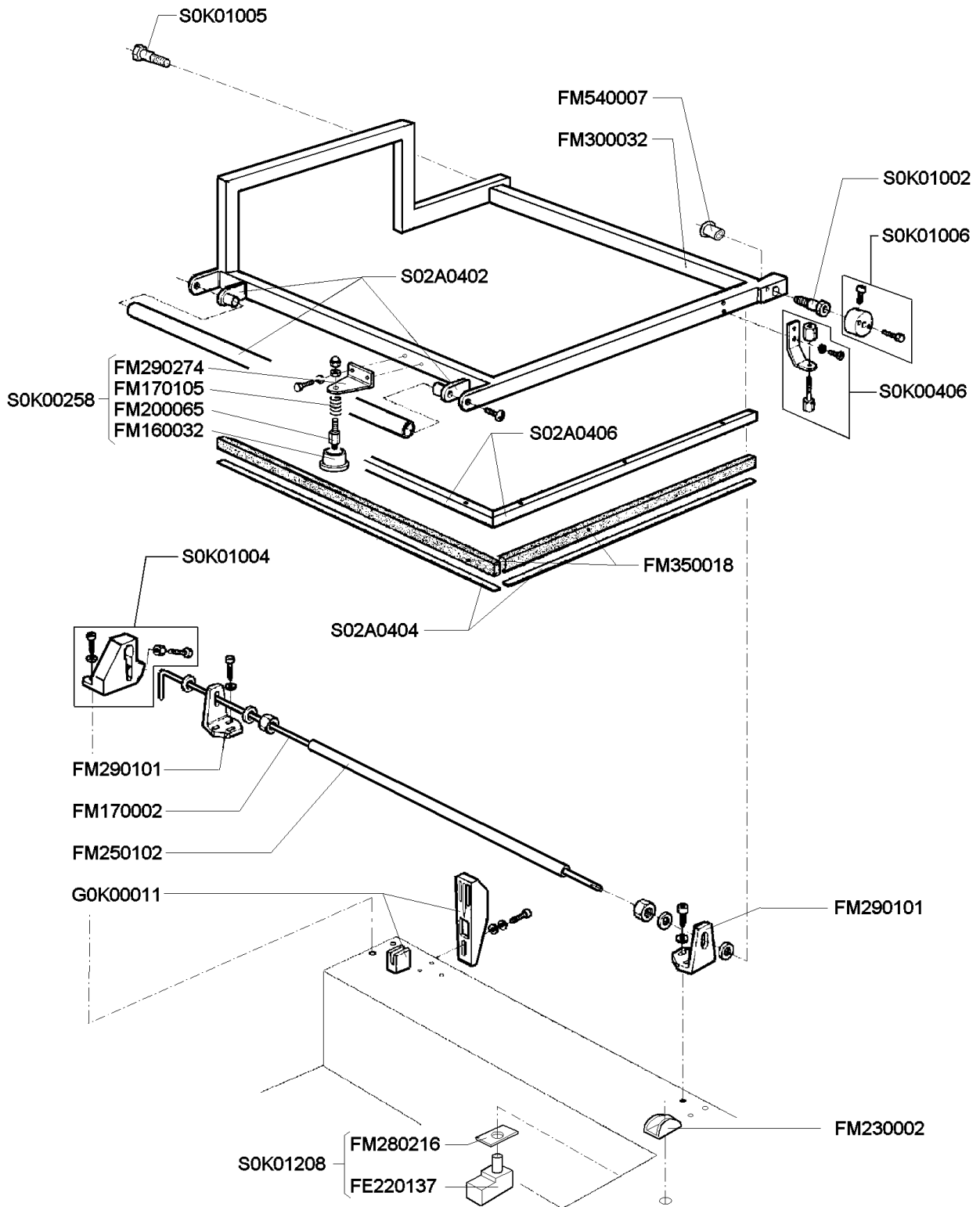

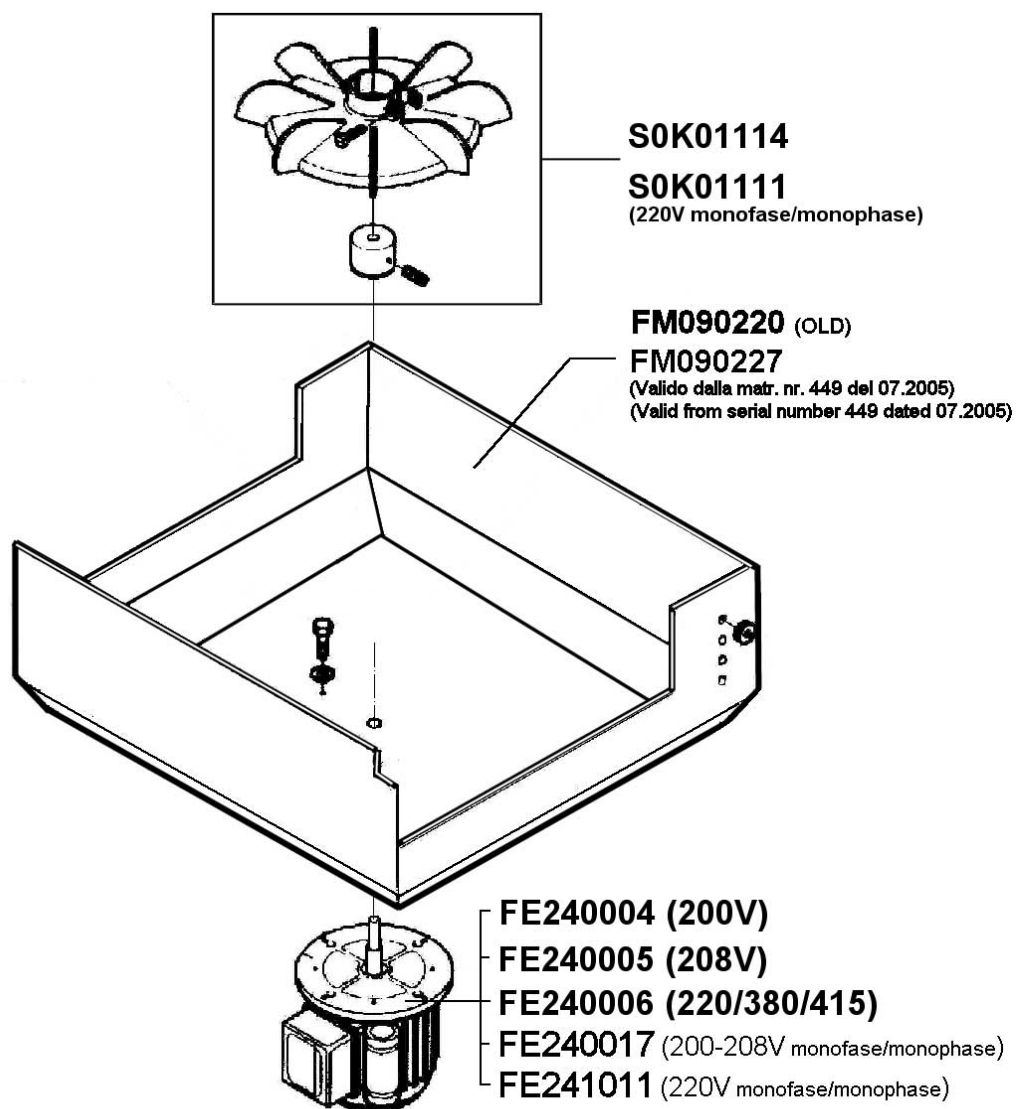

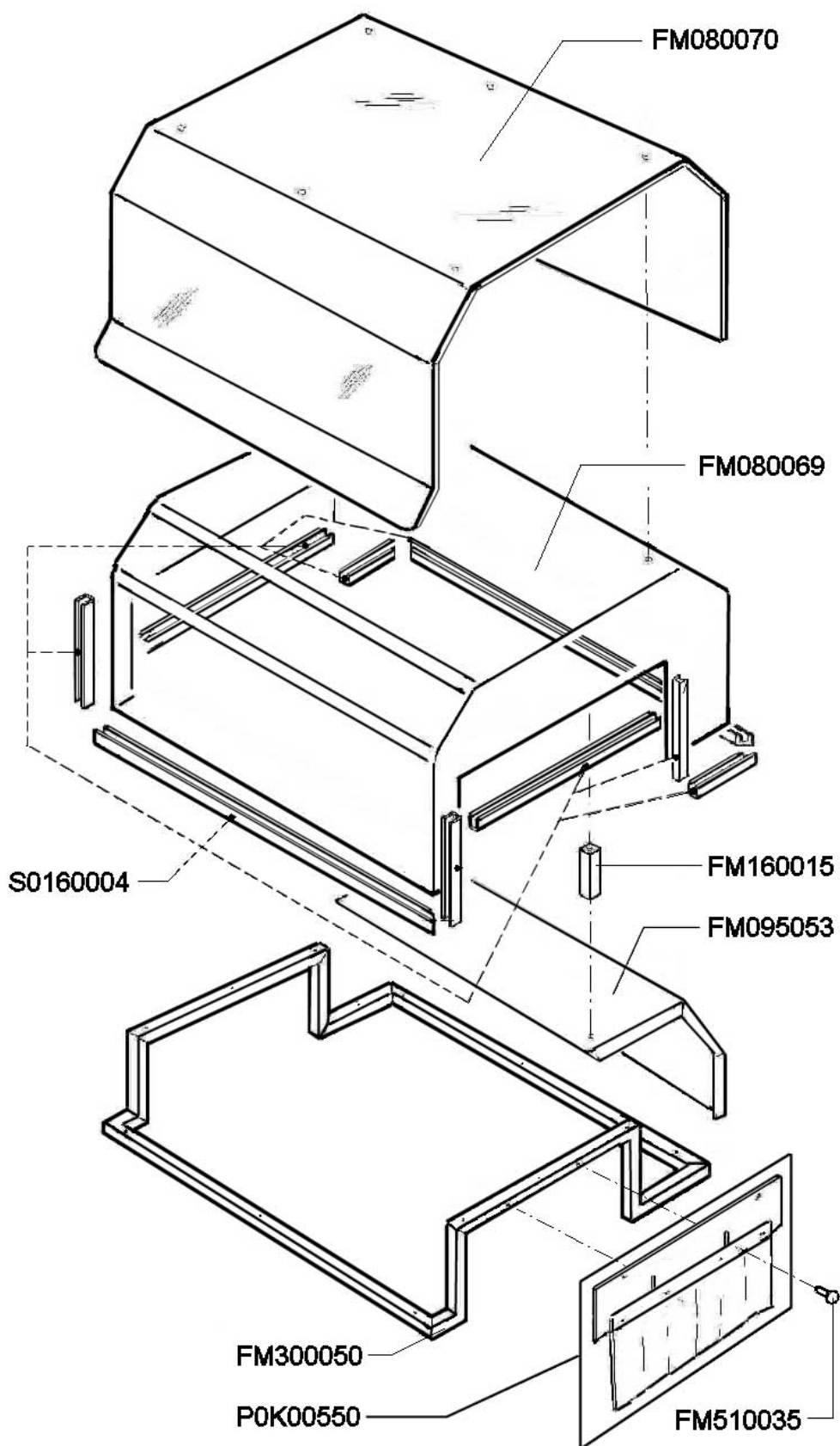

S0K00604

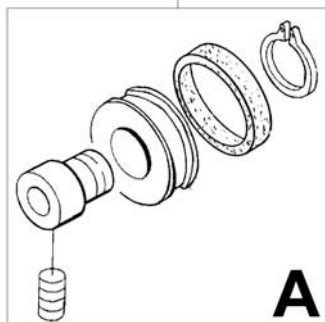

S0K00605

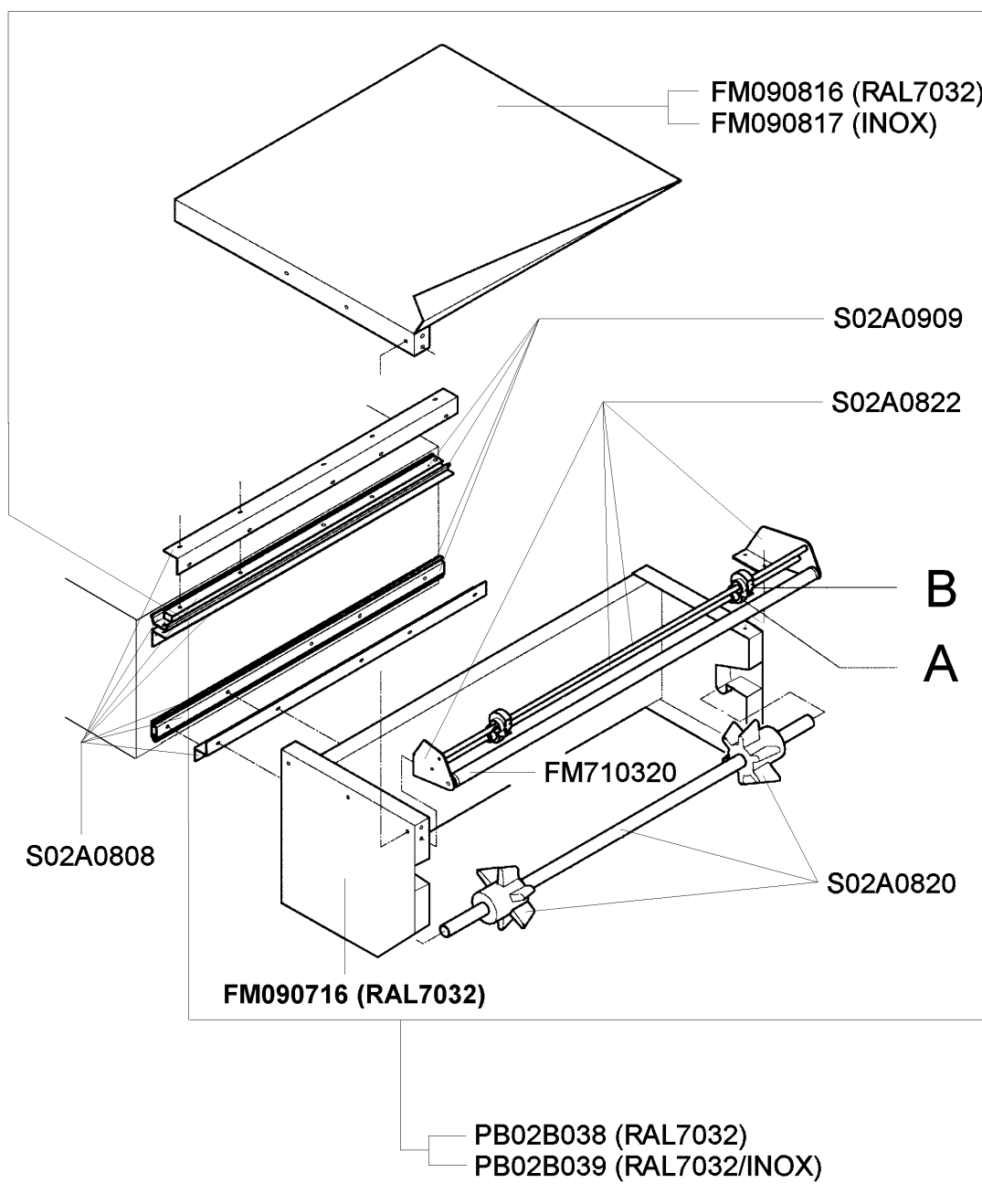
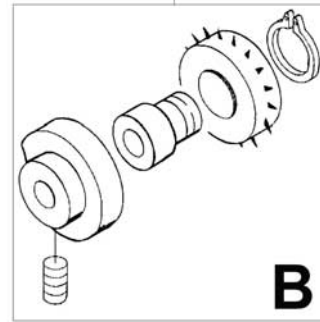



**GRUPPO NASTRO TRASPORTATORE**  
**CONVEYOR BELT GROUP**

**TAVOLA 6**  
**SCHEME 6**

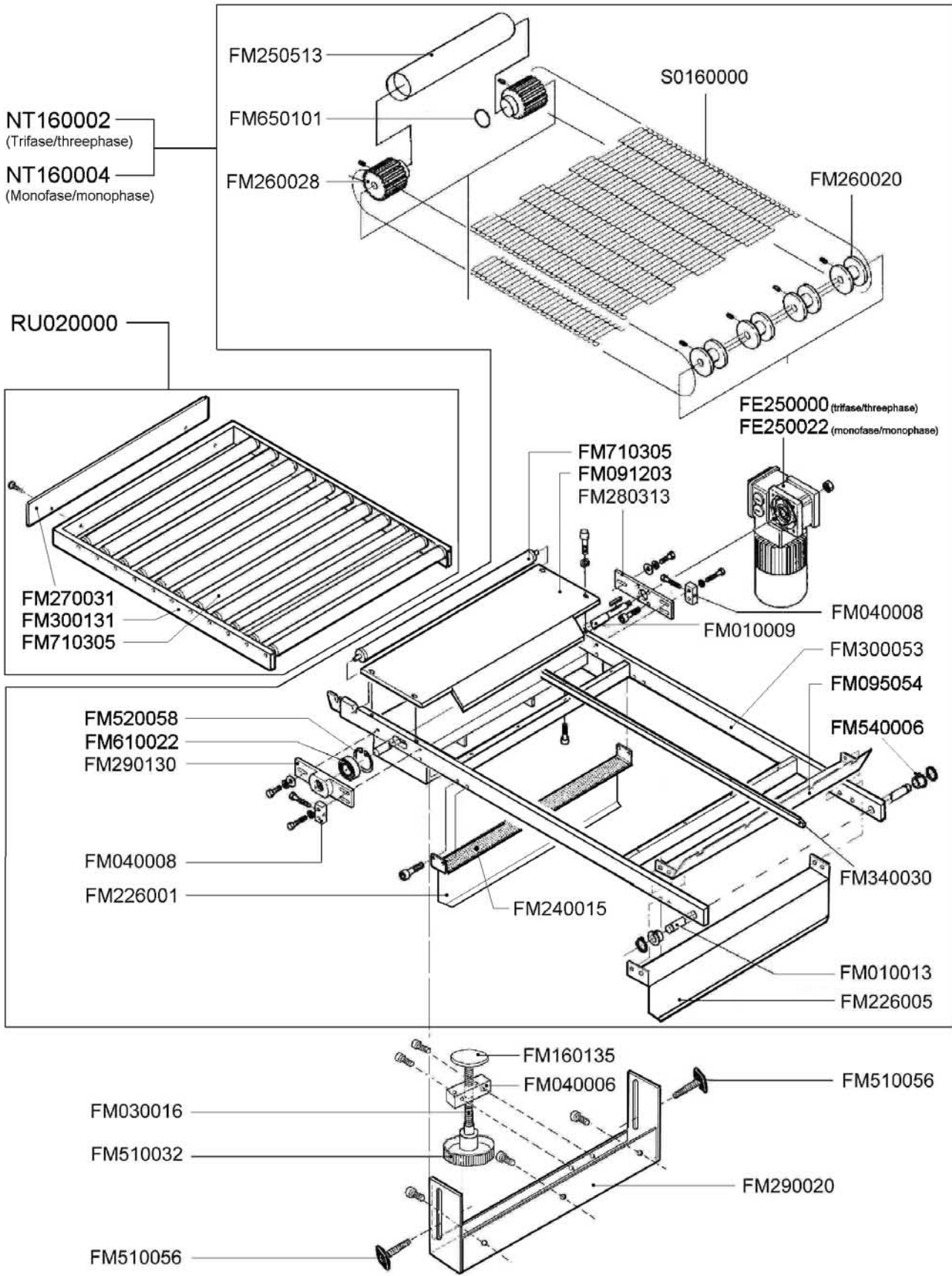

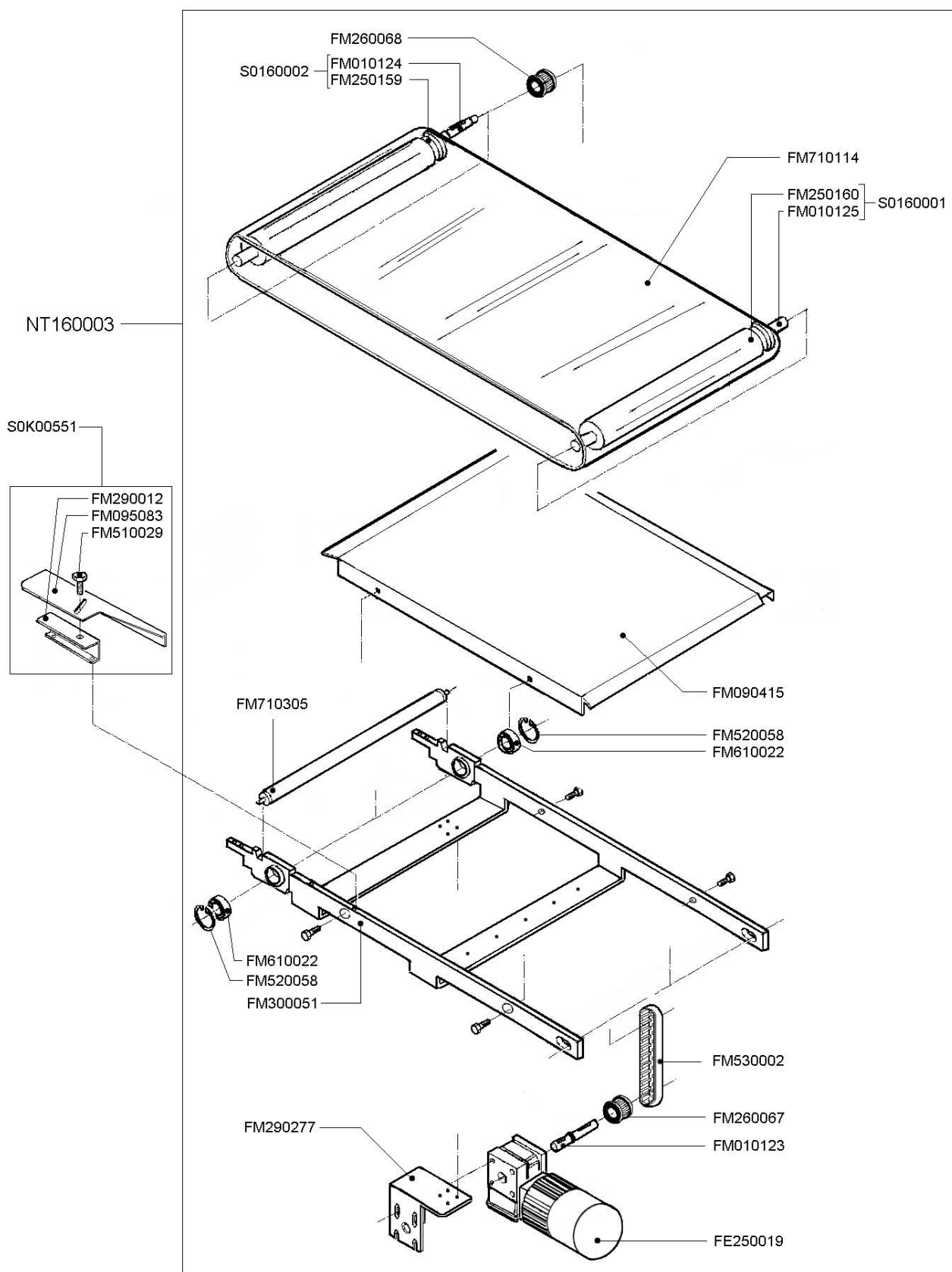

Versione valida dalla matricola nr. 449 del 07.2005  
Version valid from serial number 449 dated 07.2005

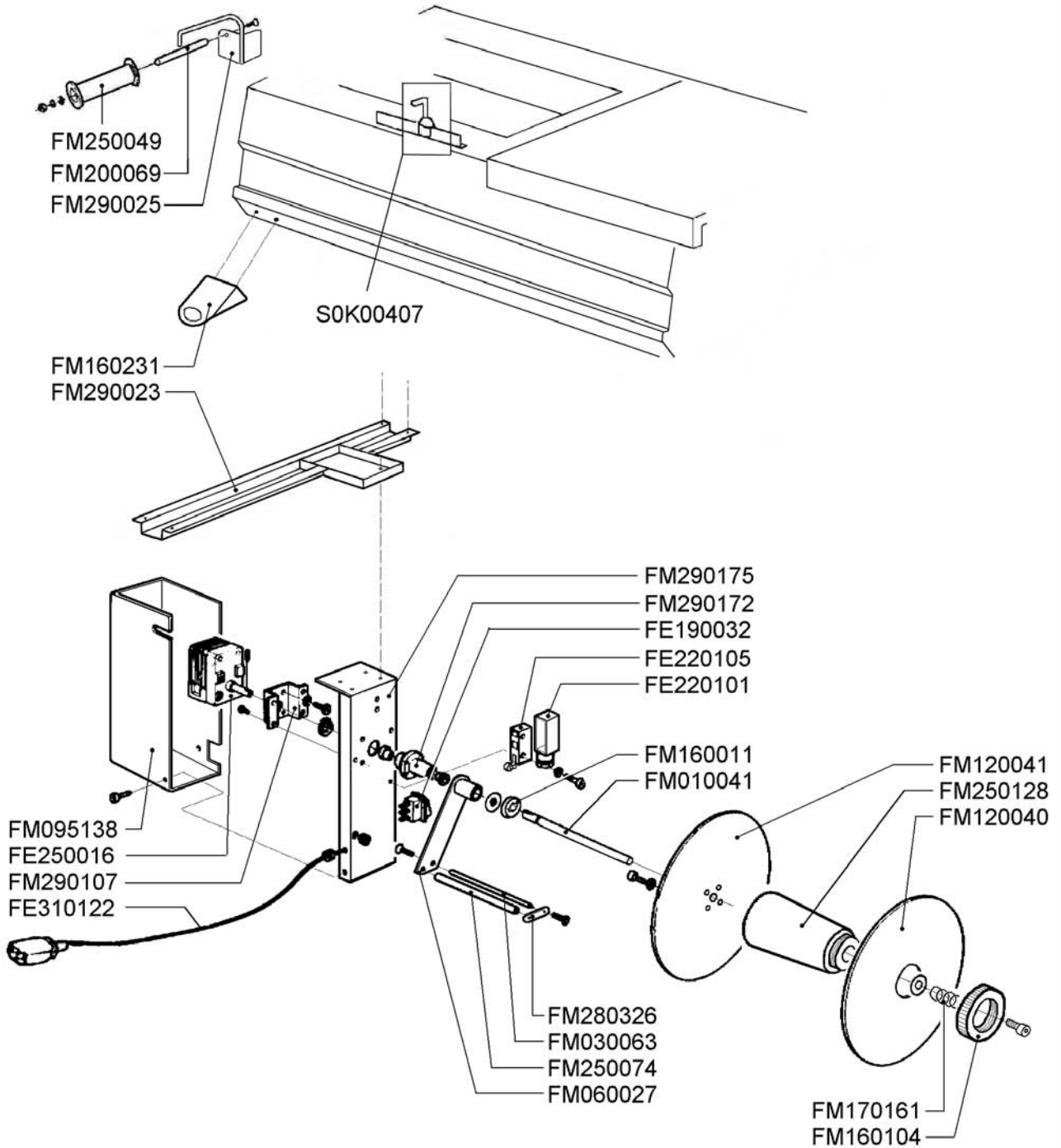

PANNELLO COMANDI  
CONTROL PANEL

TAVOLA 9  
SCHEME 9

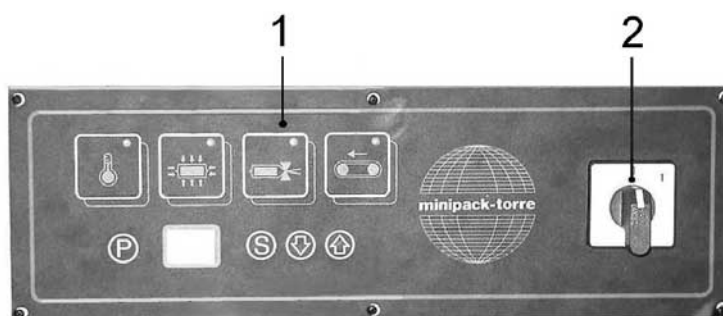

POS. POS.	CODICI PARTICOLARI ITEMS CODE	DENOMINAZIONI PARTICOLARI ITEMS DESCRIPTION	Q.tà Q.ty
1	S0190010	Pannello + scheda elettronica / Panel + electronic board	1
1.1	FM110135	Membrana adesiva / Adhesive label	1
1.2	SM190037	Pannello / Panel	1
1.3	FE120230	Scheda elettronica / Electronic board	1
2	FE080001 FE080000	Commutatore 0-1 3P 16A (380-415V) / Switch 0-1 3P 16A (380-415V) Commutatore 0-1 3P 32A (200-208-220V) / Switch 0-1 3P 32A (200-208-220V)	1

**CASSETTO ELETTRICO TRIFASE  
THREEPHASE WIRING BOX**

**TAVOLA 10.1  
SCHEME 10.1**

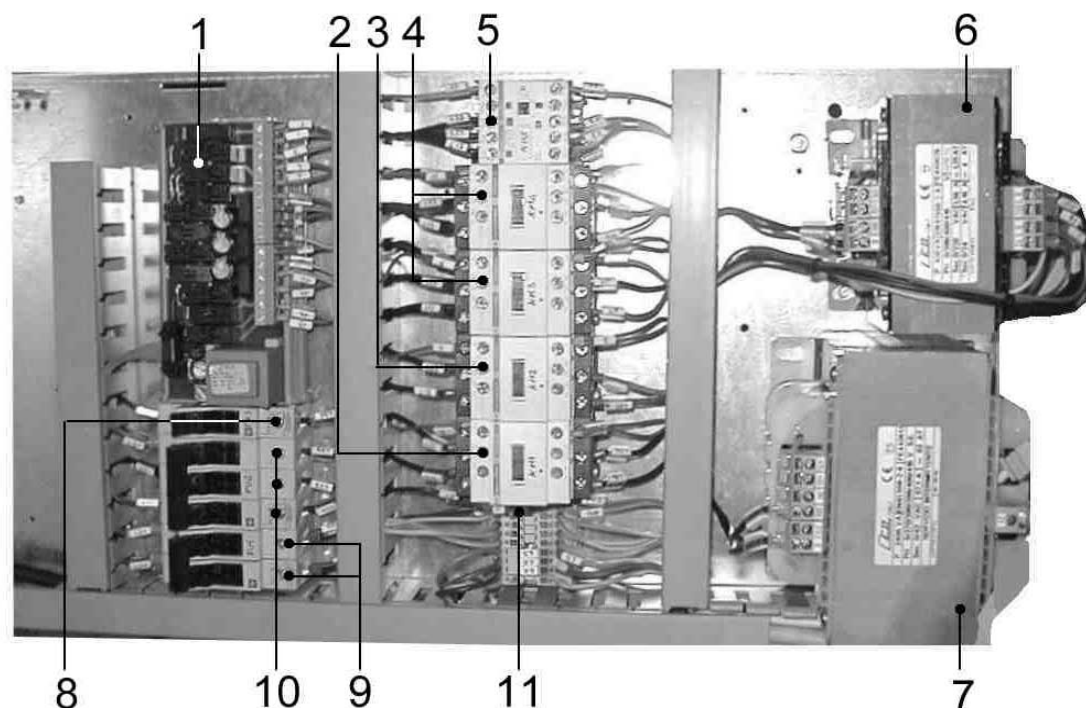

POS. POS.	CODICI PARTICOLARI ITEMS CODE	DENOMINAZIONI PARTICOLARI ITEMS DESCRIPTION	Q.tà Q.ty
1	FE120330	Modulo potenza / Power board	1
2	FE110615	Contattore LC1-D18B7 / Contactor LC1-D18B7	1
3	FE110602 FE110615	Contattore LC1-D09B7 (380/415V) / Contactor LC1-D09B7 (380/415V) Contattore LC1-D18B7 (200/208/220V) / Contactor LC1-D18B7 (200/208/220V)	1
4	FE110602	Contattore LC1-D09B7 / Contactor LC1-D09B7	2
5	FE110305	Contattore LP4-K0910BW3 / Contactor LP4-K0910BW3	1
6	FE440026 FE440025	Trasformatore 400VA (380/415V) / Transformer 400VA (380/415V) Trasformatore 400VA (200/208/220V) / Transformer 400VA (200/208/220V)	1
7	FE440613 FE440612	Trasformatore 2400VA (380/415V) / Transformer 2400VA (380/415V) Trasformatore 2400VA (200/208/220V) / Transformer 2400VA (200/208/220V)	1
8	FE290400 FE290401	Fusibile 10.3X38 1A (380/415V) / Fuse 10.3X38 1A (380/415V) Fusibile 10.3X38 2A (200/208/220V) / Fuse 10.3X38 2A (200/208/220V)	1
9	FE290407 FE290408	Fusibile 10.3X38 16A (380/415V) / Fuse 10.3X38 16A (380/415V) Fusibile 10.3X38 20A (200/208/220V) / Fuse 10.3X38 20A (200/208/220V)	2
10	FE290401 FE290402	Fusibile 10.3X38 2A (380/415V) / Fuse 10.3X38 2A (380/415V) Fusibile 10.3X38 4A (200/208/220V) / Fuse 10.3X38 4A (200/208/220V)	3
11	FE290117	Fusibile 5X20 T1A / Fuse 5X20 T1A	1

CASSETTO ELETTRICO MONOFASE  
MONOPHASE WIRING BOX

TAVOLA 10.2  
SCHEME 10.2

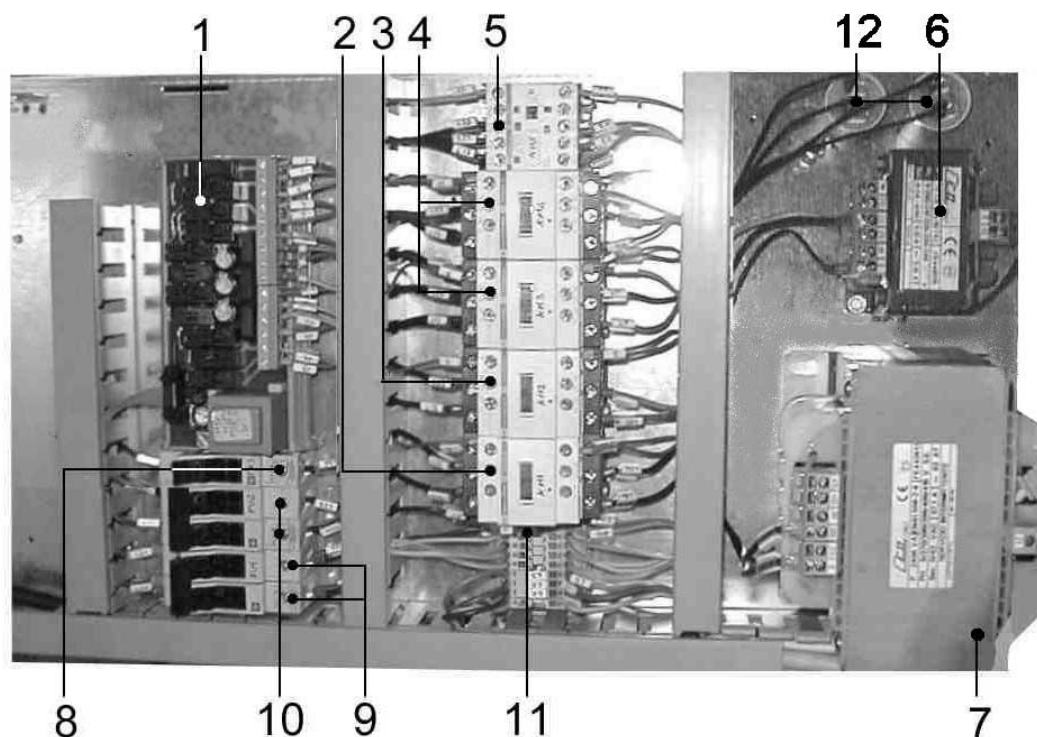

POS. POS.	CODICI PARTICOLARI ITEMS CODE	DENOMINAZIONI PARTICOLARI ITEMS DESCRIPTION	Q.tà Q.ty
1	FE120330	Modulo potenza / Power board	1
2	FE110615	Contattore LC1-D18B7 / Contactor LC1-D18B7	1
3	FE110615	Contattore LC1-D18B7 (200/208/220V) / Contactor LC1-D18B7 (200/208/220V)	1
4	FE110602	Contattore LC1-D09B7 / Contactor LC1-D09B7	2
5	FE110305	Contattore LP4-K0910BW3 / Contactor LP4-K0910BW3	1
6	FE440015	Trasformatore 75VA (200/208/220V) / Transformer 75VA (200/208/220V)	1
7	FE440612	Trasformatore 2400VA (200/208/220V) / Transformer 2400VA (200/208/220V)	1
8	FE290410	Fusibile 10.3X38 0,5A (200/208/220V) / Fuse 10.3X38 0,5A (200/208/220V)	1
9	FE290408	Fusibile 10.3X38 20A (200/208/220V) / Fuse 10.3X38 20A (200/208/220V)	2
10	FE290402	Fusibile 10.3X38 4A (200/208/220V) / Fuse 10.3X38 4A (200/208/220V)	2
11	FE290117	Fusibile 5X20 T1A / Fuse 5X20 T1A	1
12	FE088001	Condensatore mf8 V450 / Condenser mf8 V450	

# SCHEMA ELETTRICO TRIFASE THREEPHASE WIRING DIAGRAM

# TAVOLA 11.1 SCHEME 11.1

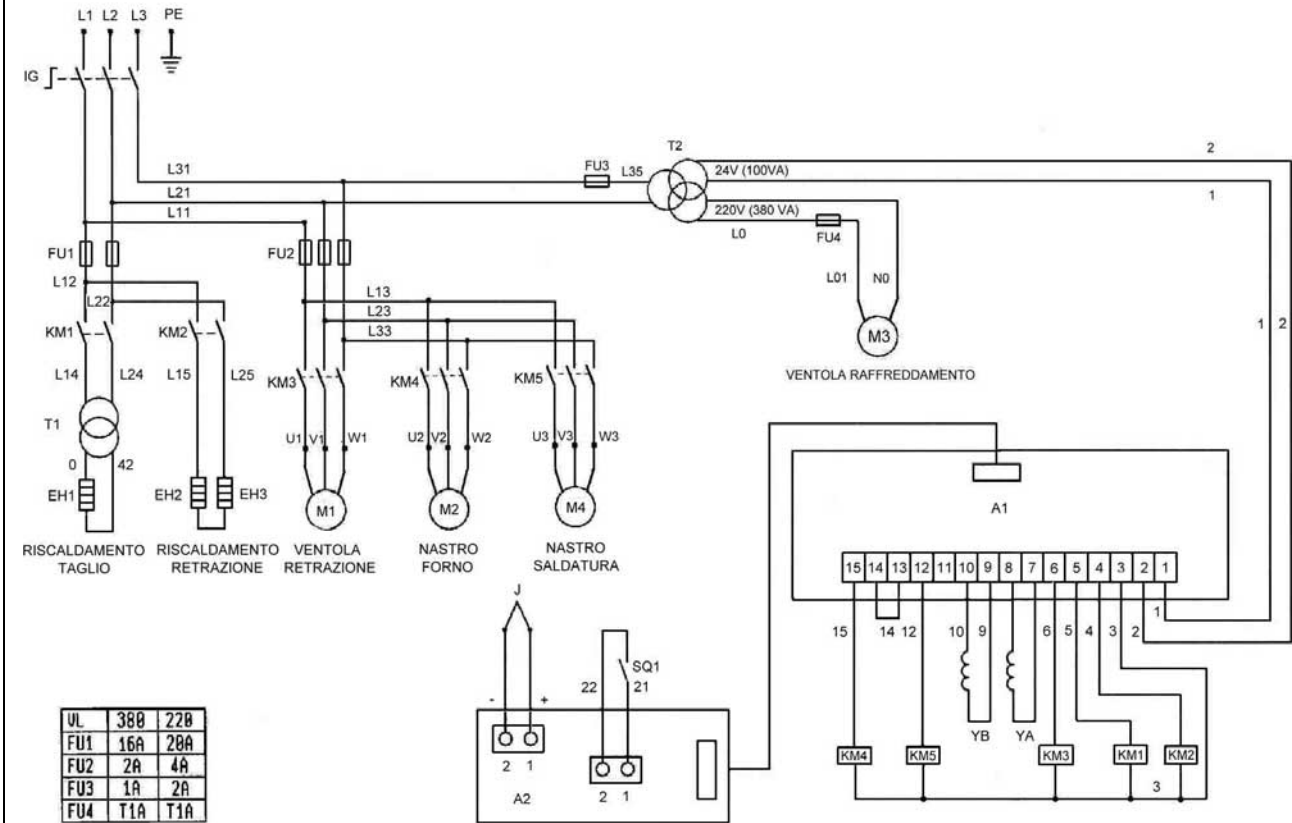

- |     |                                         |                                  |
|-----|-----------------------------------------|----------------------------------|
| IG  | Interruttore generale                   | Main switch                      |
| FU1 | Fusibile generale saldatura / resistori | General fuse cutting / heater    |
| FU2 | Fusibile nastri / ventola retrazione    | Oven tunnel / shrinking fan fuse |
| FU3 | Fusibile trasformatore ausiliario       | Auxiliary transformer fuse       |
| FU4 | Fusibile motore ventola                 | Fan motor fuse                   |
| EH1 | Resistenza lama saldatura               | Sealing blade heater             |
| EH2 | Resistenza                              | Heater                           |
| EH3 | Resistenza                              | Heater                           |
| T1  | Trasformatore saldatura                 | Sealing transformer              |
| T2  | Trasformatore ausiliari                 | Auxiliary transformer            |
| J   | Termocoppia                             | Thermocouple                     |
| SQ1 | Micro start                             | Machine cycle limit switch       |
| A1  | Modulo potenza                          | Electronic control board         |
| A2  | Scheda comando                          | Control board                    |
| KM1 | Contattore lama saldatura               | Sealing blade contactor          |
| KM2 | Contattore resistenze                   | Heaters contactor                |
| KM3 | Contattore motore ventola               | Fan motor contactor              |
| KM4 | Contattore motore nastro forno          | Oven belt motor contactor        |
| KM5 | Contattore motore nastro saldatura      | Motor contactor for sealing belt |
| M1  | Motore ventola retrazione               | Shrinking fan motor              |
| M2  | Motore nastro forno                     | Oven belt motor                  |
| M3  | Motore ventola raffreddamento           | Fan motor of oven cooling        |
| M4  | Motore nastro saldatura                 | Sealing belt motor               |
| M5  | Motore ventola x motore retrazione      | Fan motor of shrinking motor     |
| YA  | Elettromagnete retrazione               | Shrinking magnet                 |
| YB  | Elettromagnete saldatura                | Sealing magnet                   |

# SCHEMA ELETTRICO MONOFASE MONOPHASE WIRING DIAGRAM

# TAVOLA 11.2 SCHEME 11.2

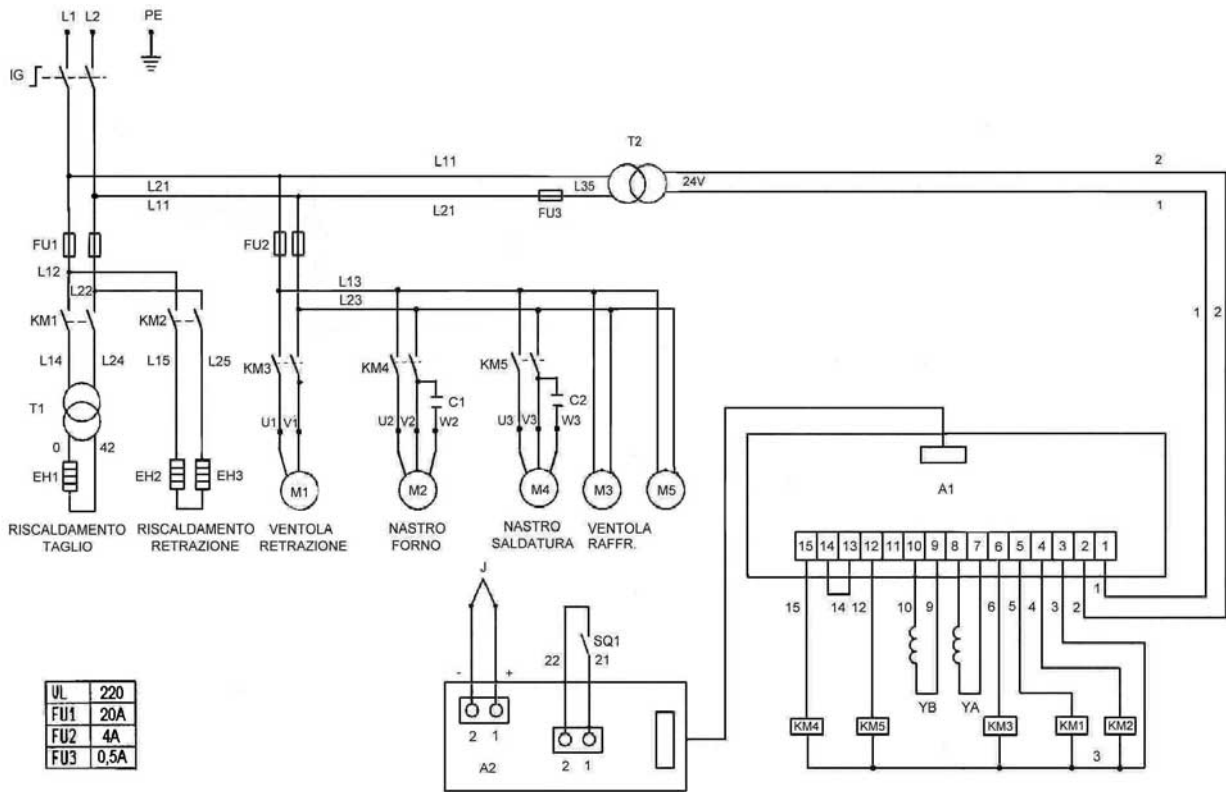

- |     |                                         |                                  |
|-----|-----------------------------------------|----------------------------------|
| IG  | Interruttore generale                   | Main switch                      |
| FU1 | Fusibile generale saldatura / resistori | General fuse cutting / heater    |
| FU2 | Fusibile nastri / ventola retrazione    | Oven tunnel / shrinking fan fuse |
| FU3 | Fusibile trasformatore ausiliario       | Auxiliary transformer fuse       |
| FU4 | Fusibile motore ventola                 | Fan motor fuse                   |
| EH1 | Resistenza lama saldatura               | Sealing blade heater             |
| EH2 | Resistenza                              | Heater                           |
| EH3 | Resistenza                              | Heater                           |
| T1  | Trasformatore saldatura                 | Sealing transformer              |
| T2  | Trasformatore ausiliari                 | Auxiliary transformer            |
| J   | Termocoppia                             | Thermocouple                     |
| SQ1 | Micro start                             | Machine cycle limit switch       |
| A1  | Modulo potenza                          | Electronic control board         |
| A2  | Scheda comando                          | Control board                    |
| KM1 | Contattore lama saldatura               | Sealing blade contactor          |
| KM2 | Contattore resistenze                   | Heaters contactor                |
| KM3 | Contattore motore ventola               | Fan motor contactor              |
| KM4 | Contattore motore nastro forno          | Oven belt motor contactor        |
| KM5 | Contattore motore nastro saldatura      | Motor contactor for sealing belt |
| M1  | Motore ventola retrazione               | Shrinking fan motor              |
| M2  | Motore nastro forno                     | Oven belt motor                  |
| M3  | Motore ventola raffreddamento           | Fan motor of oven cooling        |
| M4  | Motore nastro saldatura                 | Sealing belt motor               |
| M5  | Motore ventola x motore retrazione      | Fan motor of shrinking motor     |
| YA  | Elettromagnete retrazione               | Shrinking magnet                 |
| YB  | Elettromagnete saldatura                | Sealing magnet                   |
| C1  | Condensatore x motore nastro forno      | Condenser oven belt motor        |
| C2  | Condensatore x motore nastro saldatura  | Motor condenser for sealing belt |





**Minipack-torre S.p.A.**

Via Provinciale, 54 - 24044 DALMINE (BG) - ITALY

Tel. (035) 563525 – Fax (035) 564945

E-mail: [info@minipack-torre.it](mailto:info@minipack-torre.it)

Internet: [www.minipack-torre.it](http://www.minipack-torre.it)