



Minipack-torre S.p.A.
Via Provinciale, 54 - 24044 Dalmine (BG) - Italy
Tel. (035) 563525 – Fax (035) 564945
E-mail: info@minipack-torre.it
<http://www.minipack-torre.it>



minipack Vision Restyling

Catalogo ricambi

(Valido dalla matricola nr. 243 del 02.2002 fino alla matricola nr. 456 del 11.2008.
Escluso matricola nr. 450)

Spare parts catalogue

(Valid from serial number 243 dated 02.2002 up to 456 dated 11.2008.
With the exclusion of serial number 450)

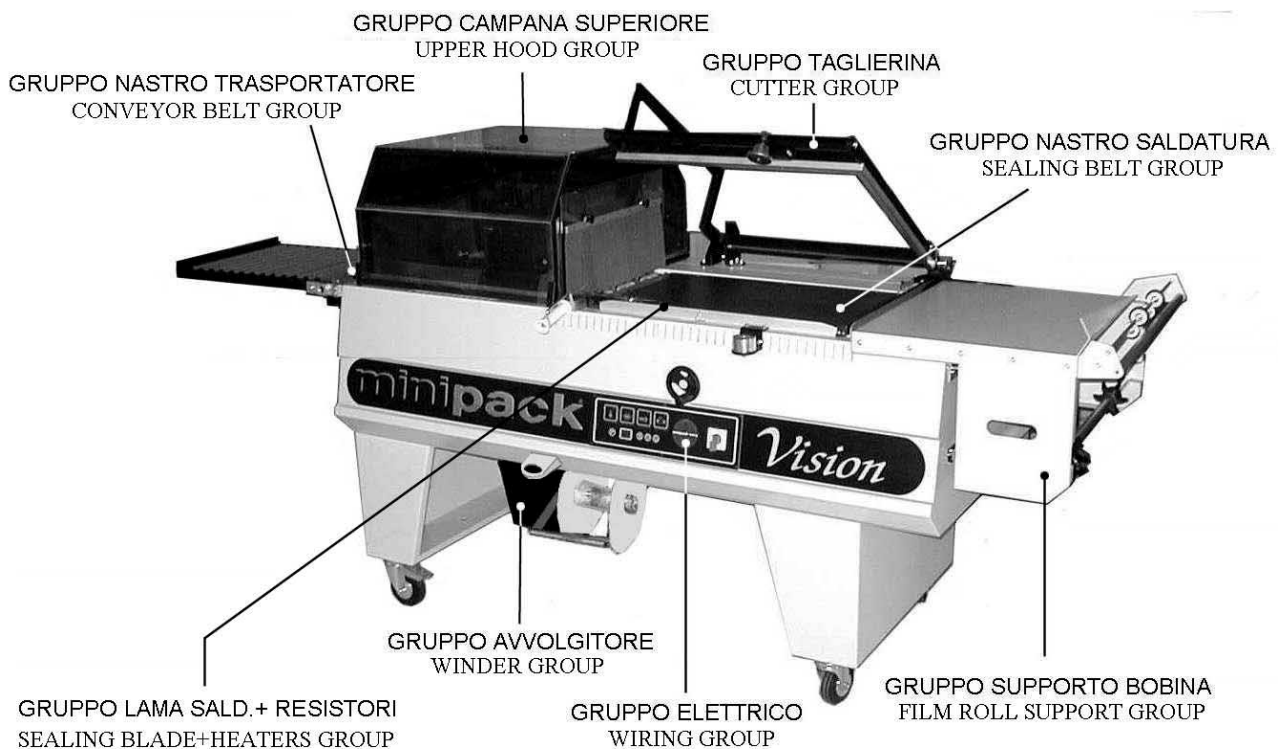

CONSULTARE ATTENTAMENTE QUESTO CATALOGO PRIMA DI ORDINARE PEZZI DI RICAMBIO
CAREFULLY READ THIS CATALOGUE BEFORE ORDERING ANY SPARE PART



DOC. N. FM112029
REV. 02
Ed: 07.2009

УПАКОВОЧНОЕ ОБОРУДОВАНИЕ



ПРОИЗВОДСТВО И ПОСТАВКА
СЕРВИСНЫЙ РЕМОНТ
ЗАПАСНЫЕ ЧАСТИ
РАСХОДНЫЕ МАТЕРИАЛЫ

Диагностика, ремонт, сервисное обслуживание.

Запасные части и расходный материал: резина, тефлоновая лента, термонож (лезвие), гель для смазки.

Плѐнка термоусадочная полиолефиновая.

Система «Trade-In» – замена Вашего оборудования на новое и более производительное.



На фото: запайщик Magnetic FL900 + туннель Magnetic T100

ООО «АРДсистемы»

(495) 231-21-00

(812) 363-20-22

info@ardsystems.ru

www.filmtrade.ru

www.ardsystems.ru

INDICE INDEX

TAVOLA NR. SCHEME N.	DESCRIZIONE DESCRIPTION	PAGINA PAGE
1	GRUPPO LAMA SALDANTE + RESISTORI SEALING BLADE + HEATERS GROUP	1
2	GRUPPO TAGLIERINA CUTTER GROUP	2
3	GRUPPO CAMPANA INFERIORE LOWER HOOD GROUP	3
4	GRUPPO CAMPANA SUPERIORE UPPER HOOD GROUP	4
5	GRUPPO SUPPORTO BOBINA FILM ROLL SUPPORT GROUP	5
6	GRUPPO NASTRO TRASPORTATORE CONVEYOR BELT GROUP	6
7	GRUPPO NASTRO SALDATURA SEALING BELT GROUP	7
8	GRUPPO AVVOLGITORE FILM FILM WINDER GROUP	8
9	PANNELLO COMANDI CONTROL PANEL	9
10.1	CASSETTO ELETTRICO TRIFASE THREEPHASE WIRING BOX	10
10.2	CASSETTO ELETTRICO MONOFASE MONOPHASE WIRING BOX	11
11.1	SCHEMA ELETTRICO TRIFASE THREEPHASE WIRING DIAGRAM	12
11.2	SCHEMA ELETTRICO MONOFASE MONOPHASE WIRING DIAGRAM	13

GRUPPO LAMA SALDANTE + RESISTORI
SEALING BLADE + HEATERS GROUP

TAVOLA 1
SCHEME 1

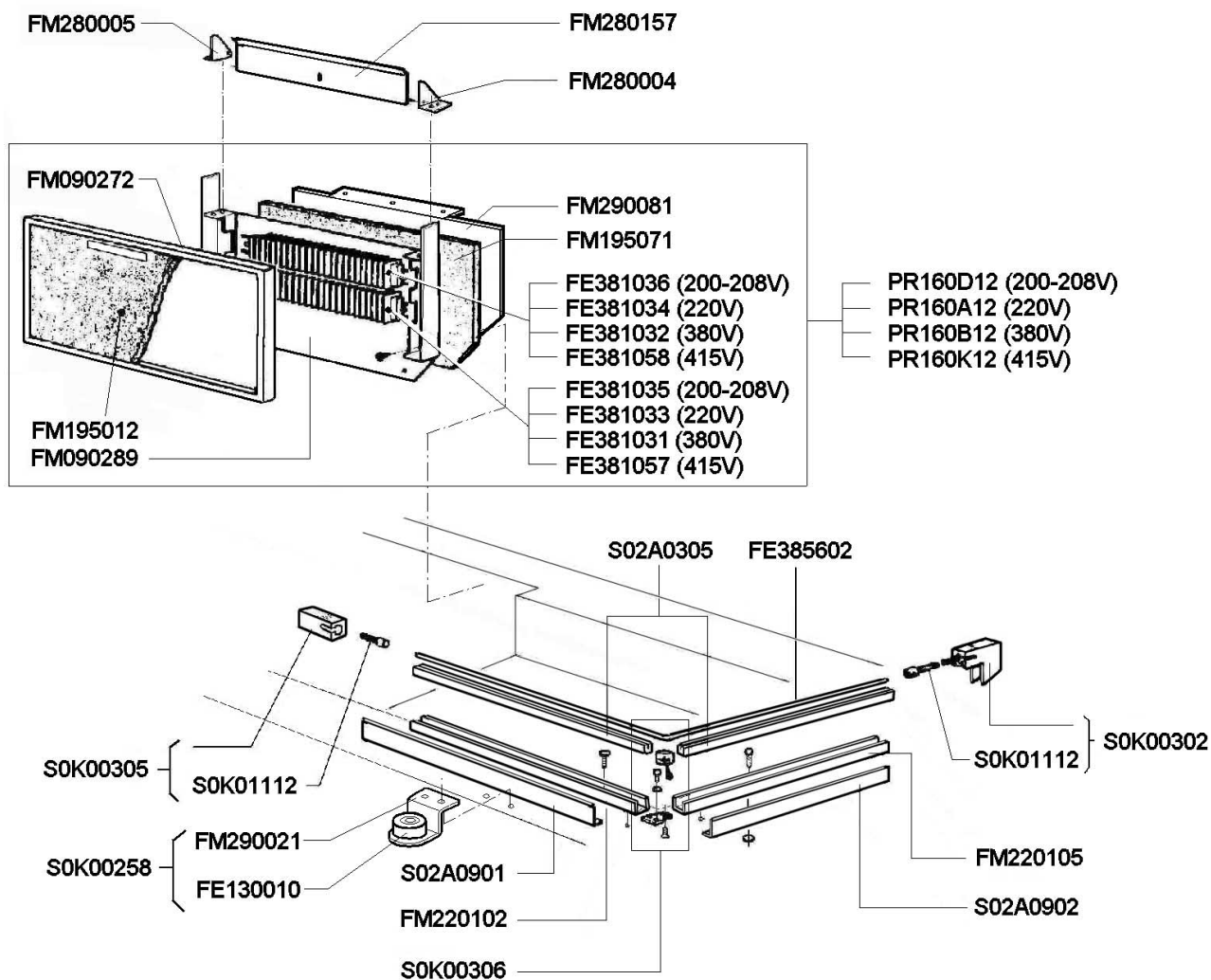

GRUPPO TAGLIERINA
CUTTER GROUP

TAVOLA 2
SCHEME 2

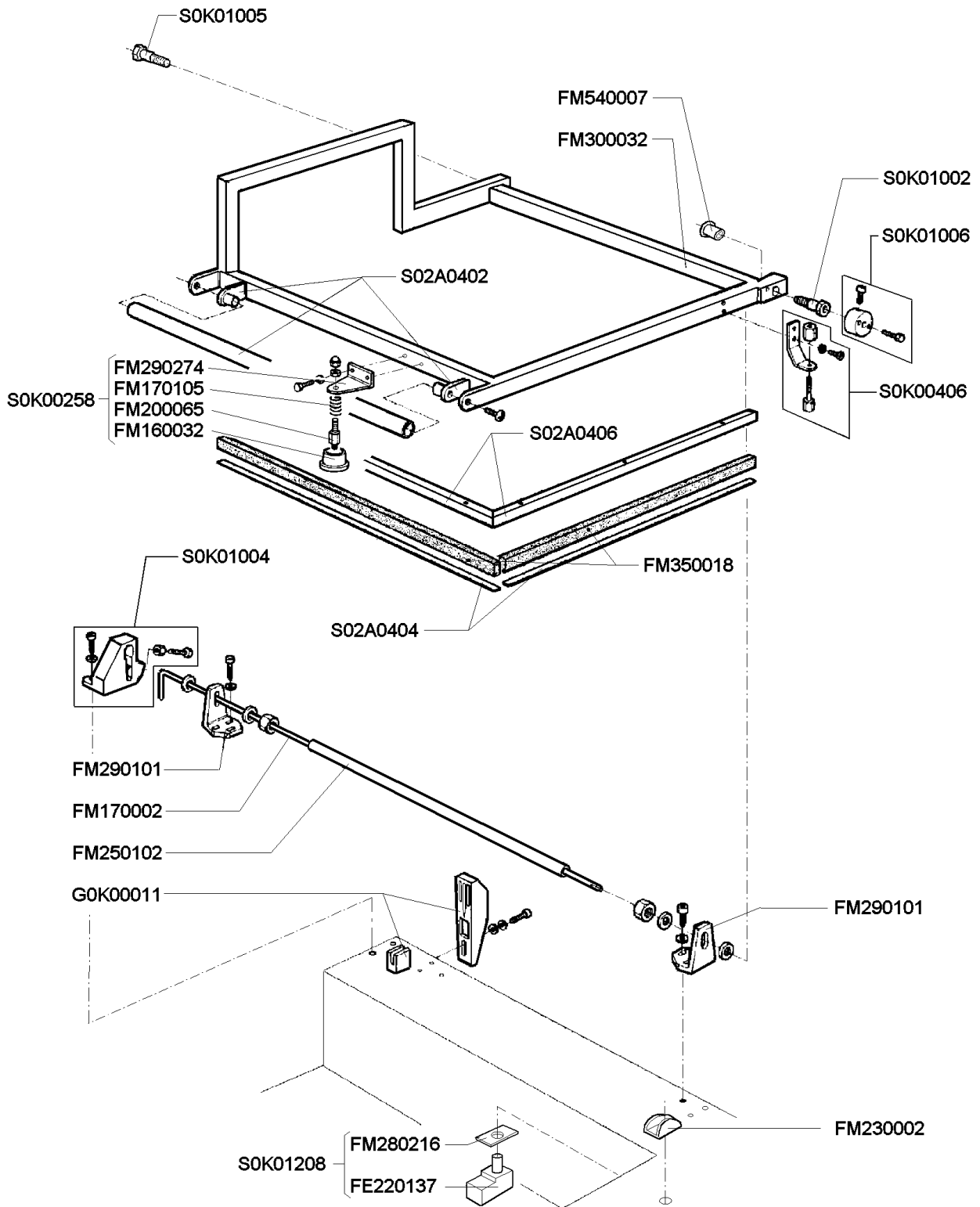

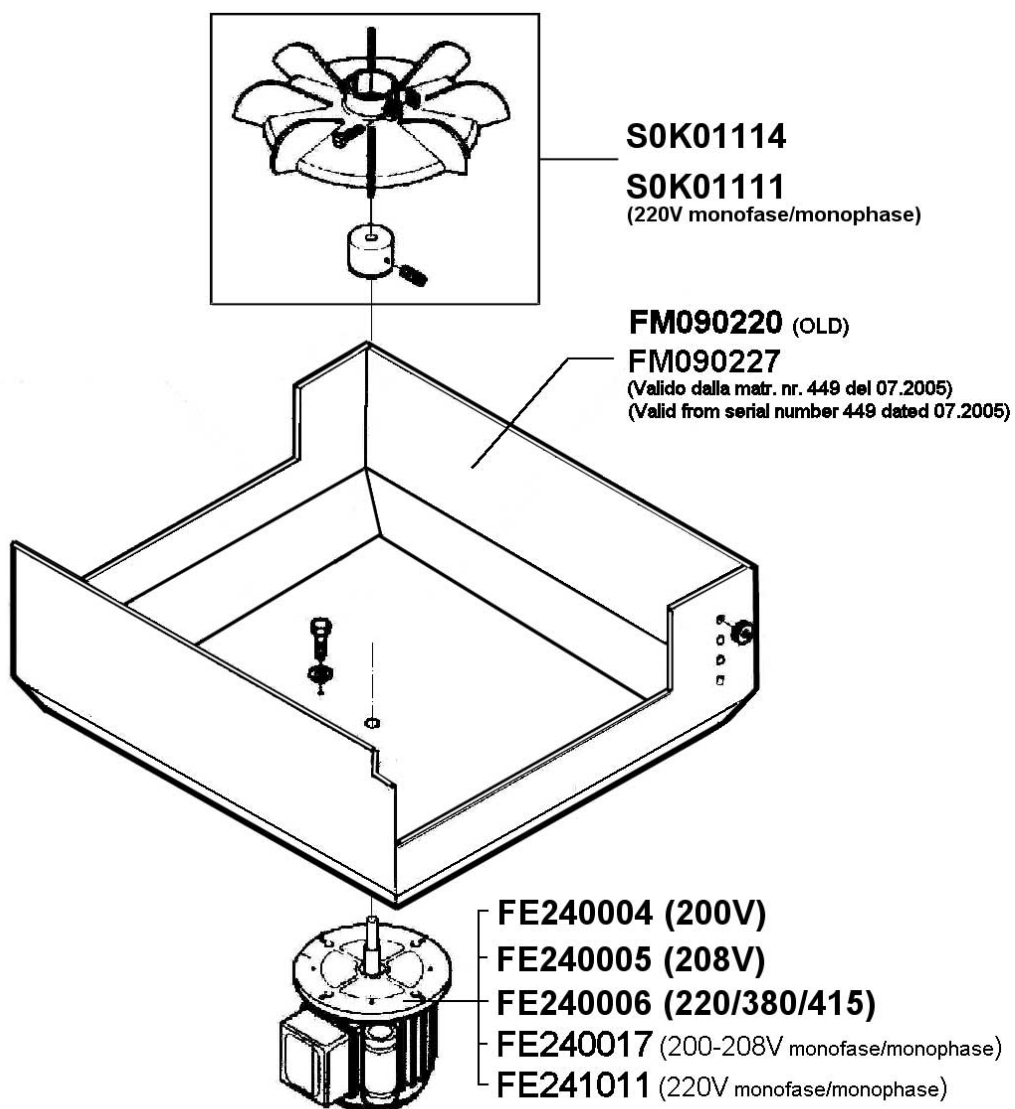

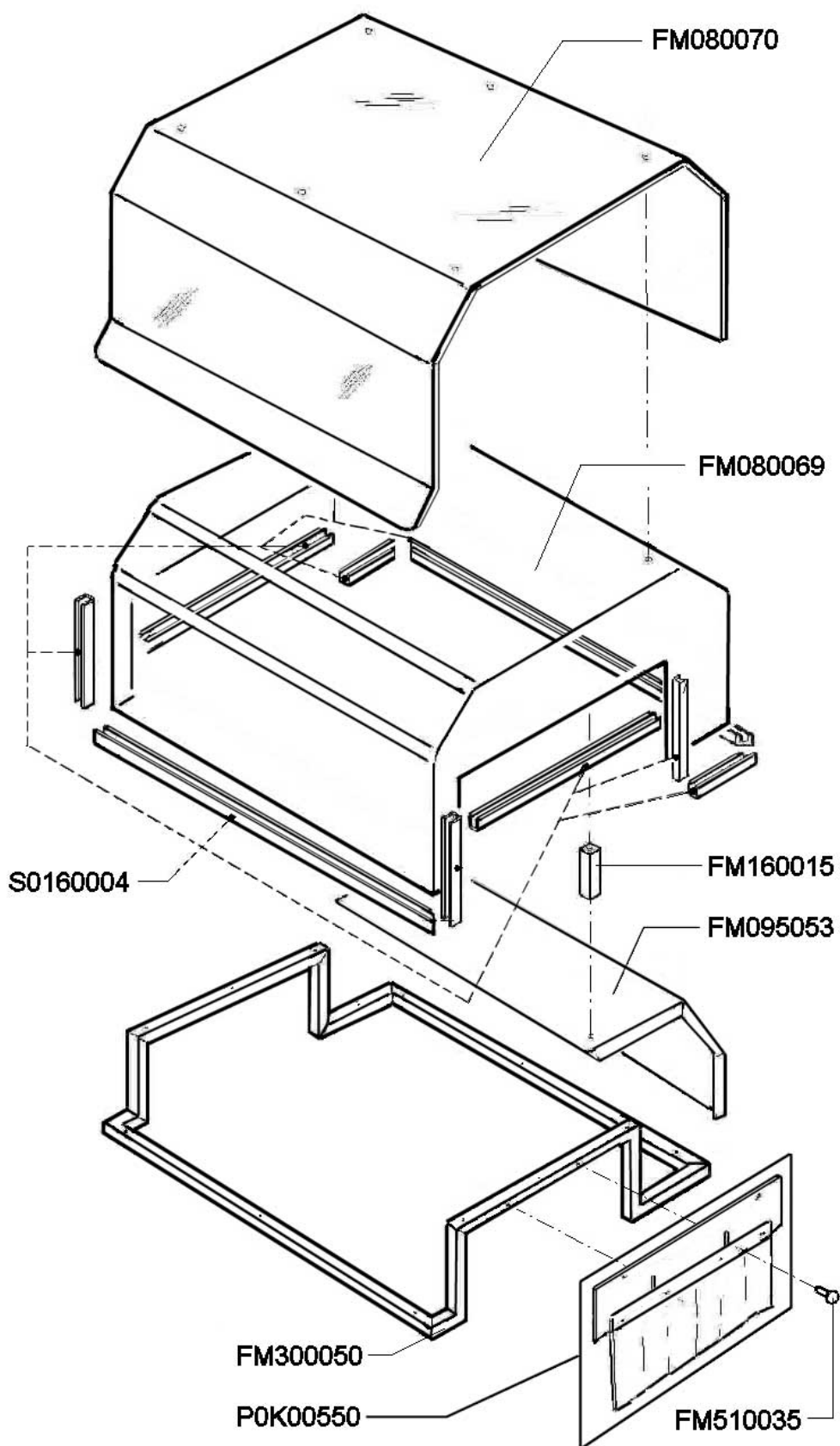

S0K00604

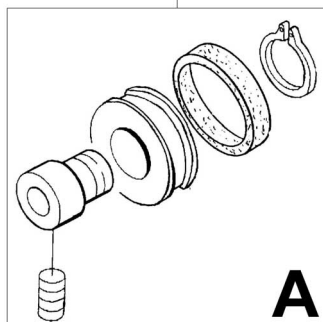

S0K00605

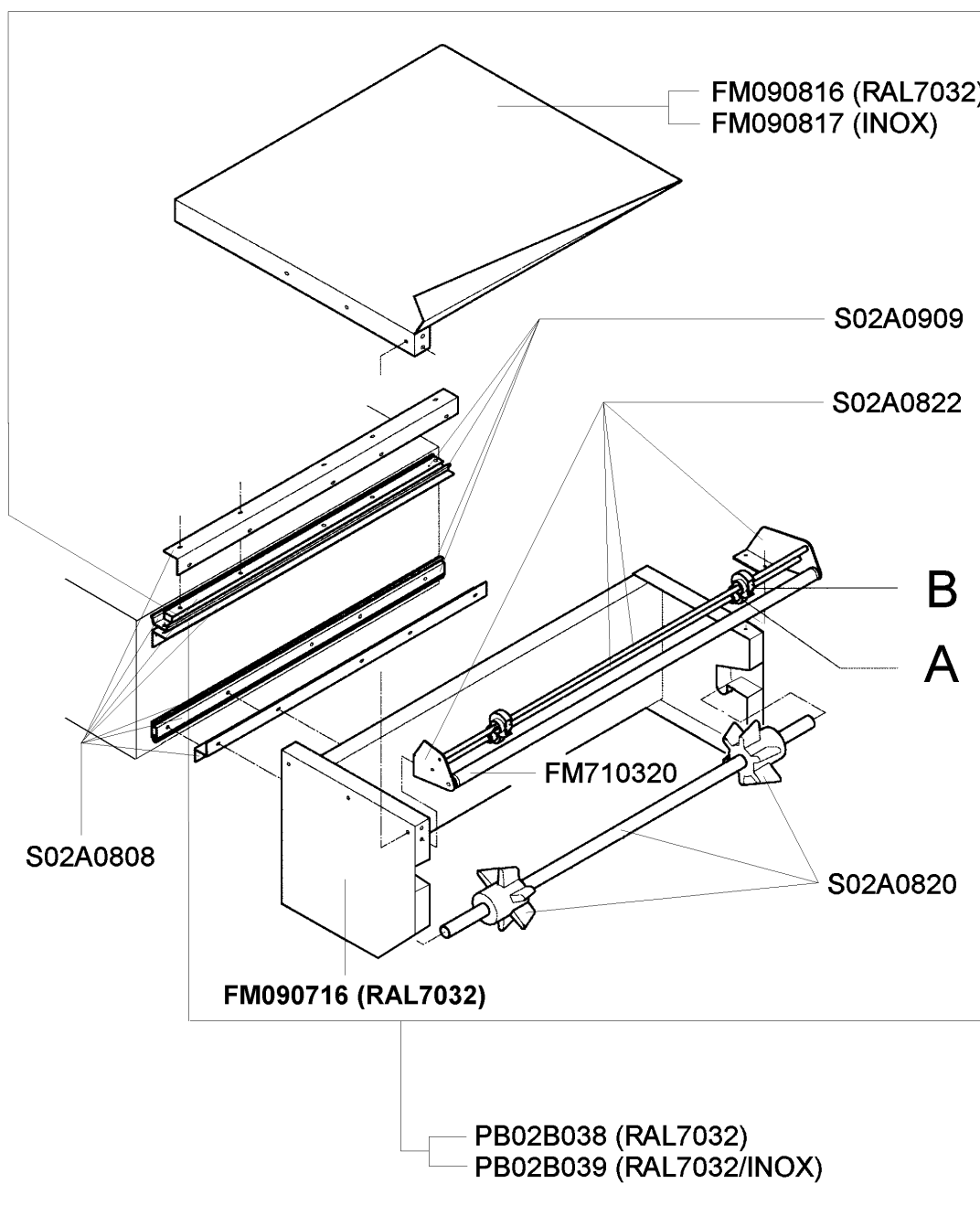
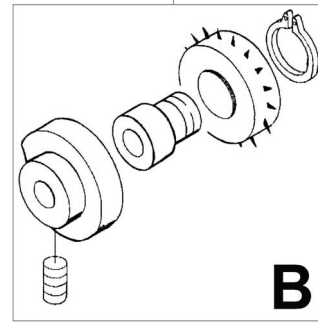

**GRUPPO NASTRO TRASPORTATORE
CONVEYOR BELT GROUP**

**TAVOLA 6
SCHEME 6**

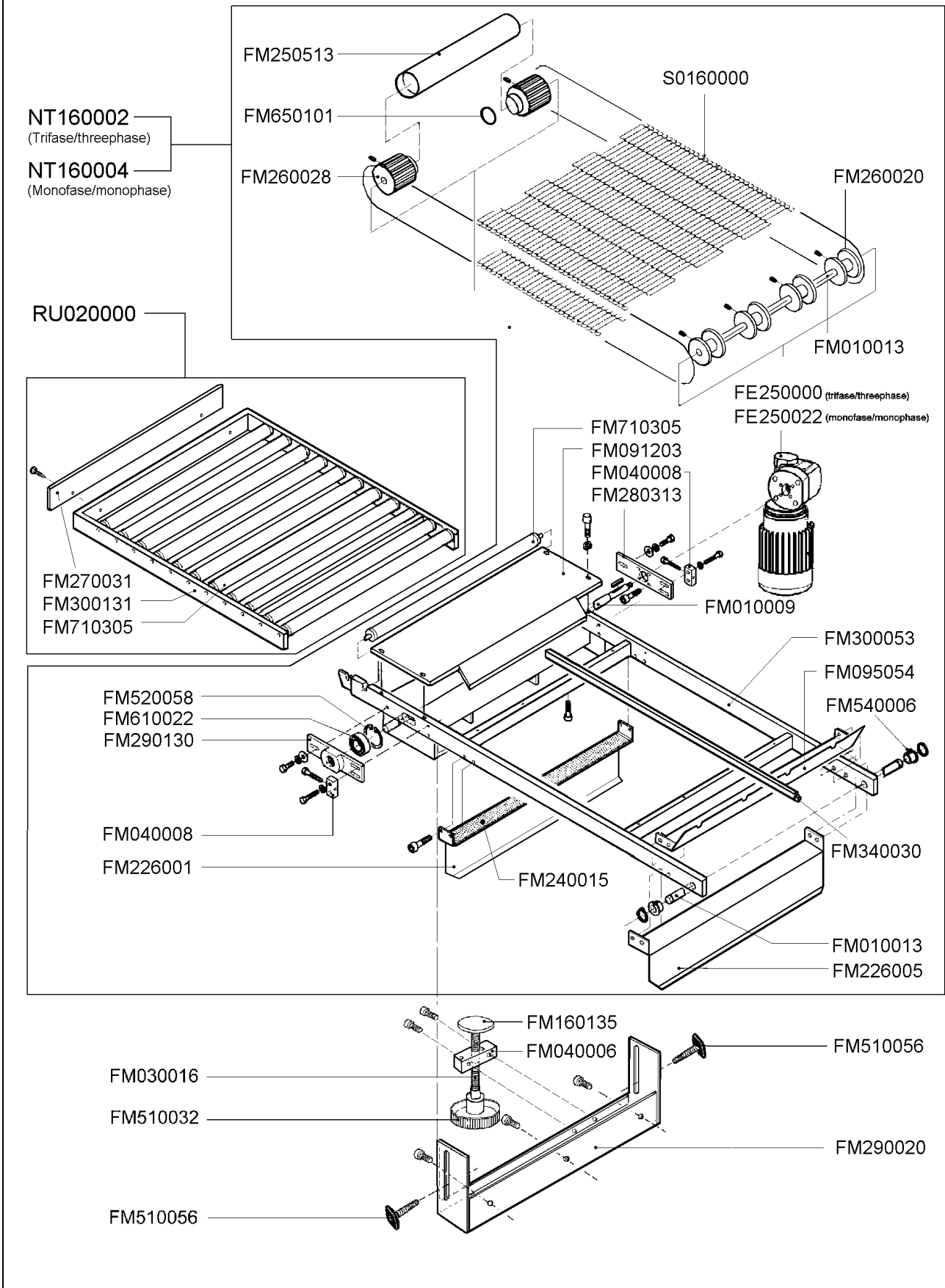

GRUPPO NASTRO SALDATURA SEALING BELT GROUP

TAVOLA 7 SCHEME 7

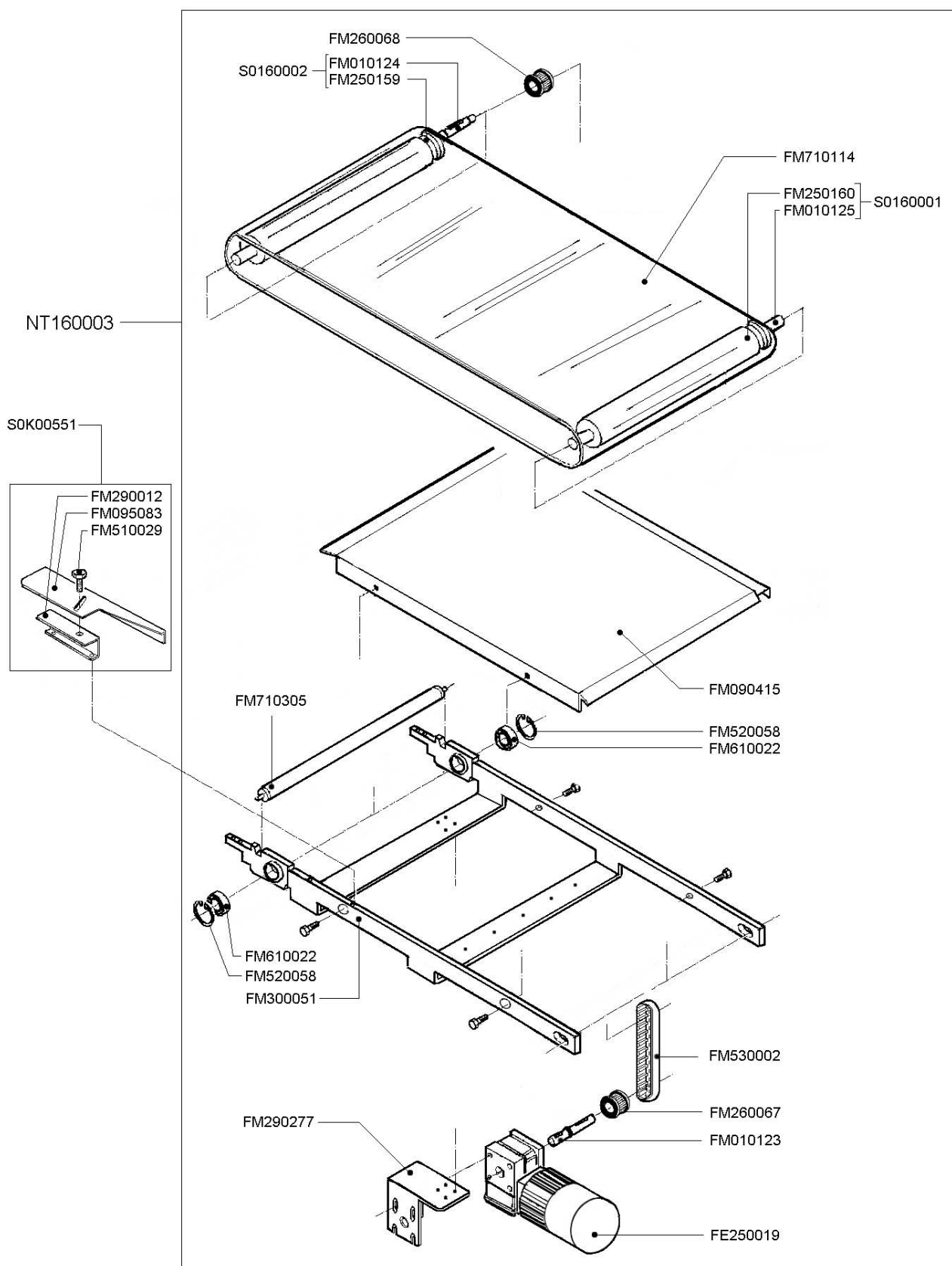

Versione valida dalla matricola nr. 449 del 07.2005
Version valid from serial number 449 dated 07.2005

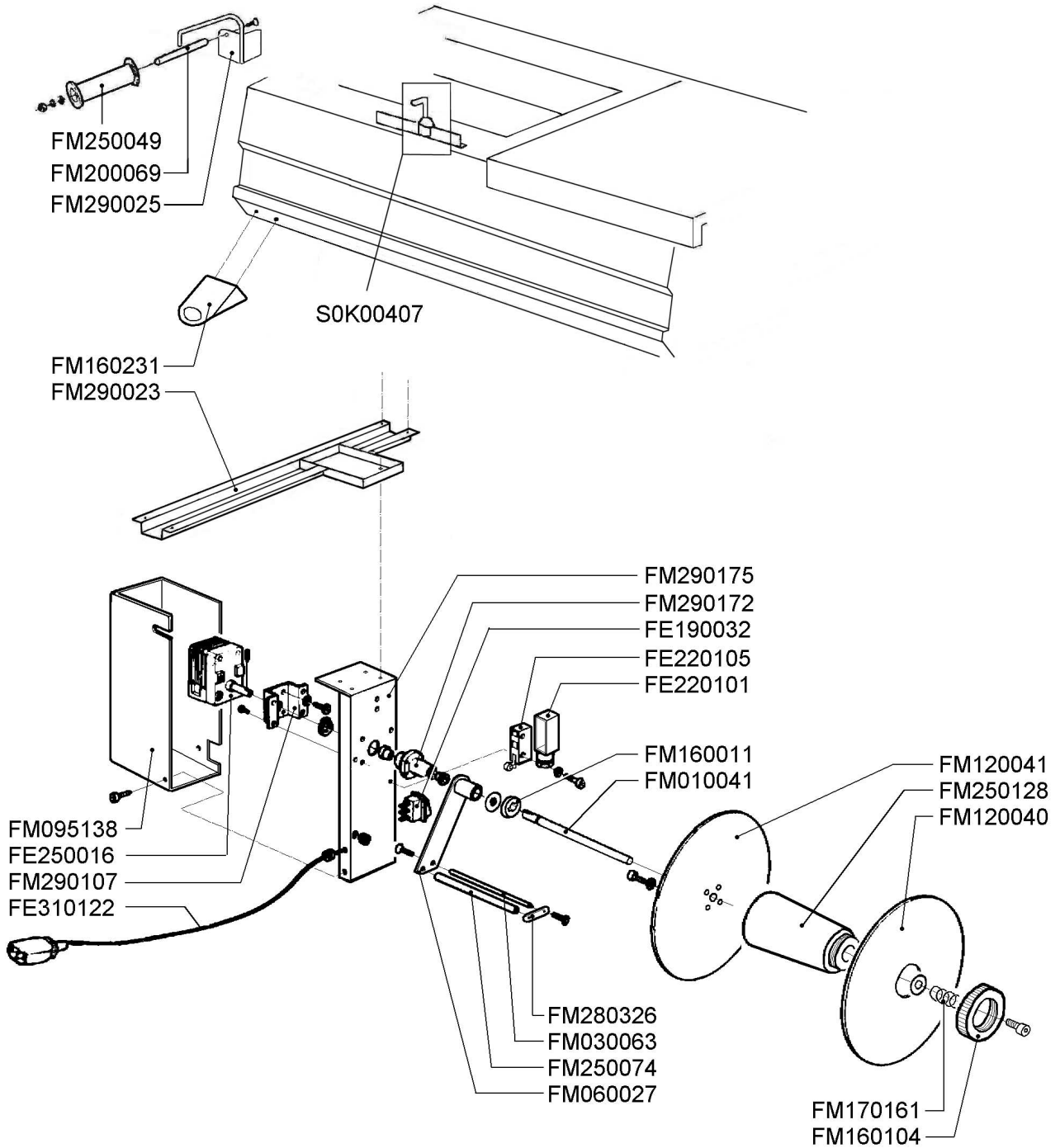

PANNELLO COMANDI
CONTROL PANEL

TAVOLA 9
SCHEME 9

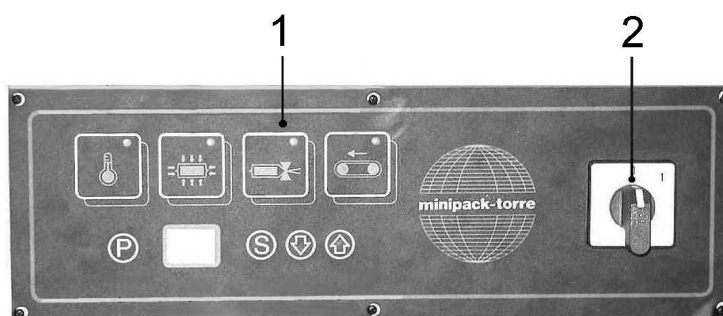

POS. POS.	CODICI PARTICOLARI ITEMS CODE	DENOMINAZIONI PARTICOLARI ITEMS DESCRIPTION	Q.tà Q.ty
1	S0190010	Pannello + scheda elettronica / Panel + electronic board	1
1.1	FM110135	Membrana adesiva / Adhesive label	1
1.2	SM190037	Pannello / Panel	1
1.3	FE120230	Scheda elettronica / Electronic board	1
2	FE080001 FE080000	Commutatore 0-1 3P 16A (380-415V) / Switch 0-1 3P 16A (380-415V) Commutatore 0-1 3P 32A (200-208-220V) / Switch 0-1 3P 32A (200-208-220V)	1

**CASSETTO ELETTRICO TRIFASE
THREEPHASE WIRING BOX**

**TAVOLA 10.1
SCHEME 10.1**

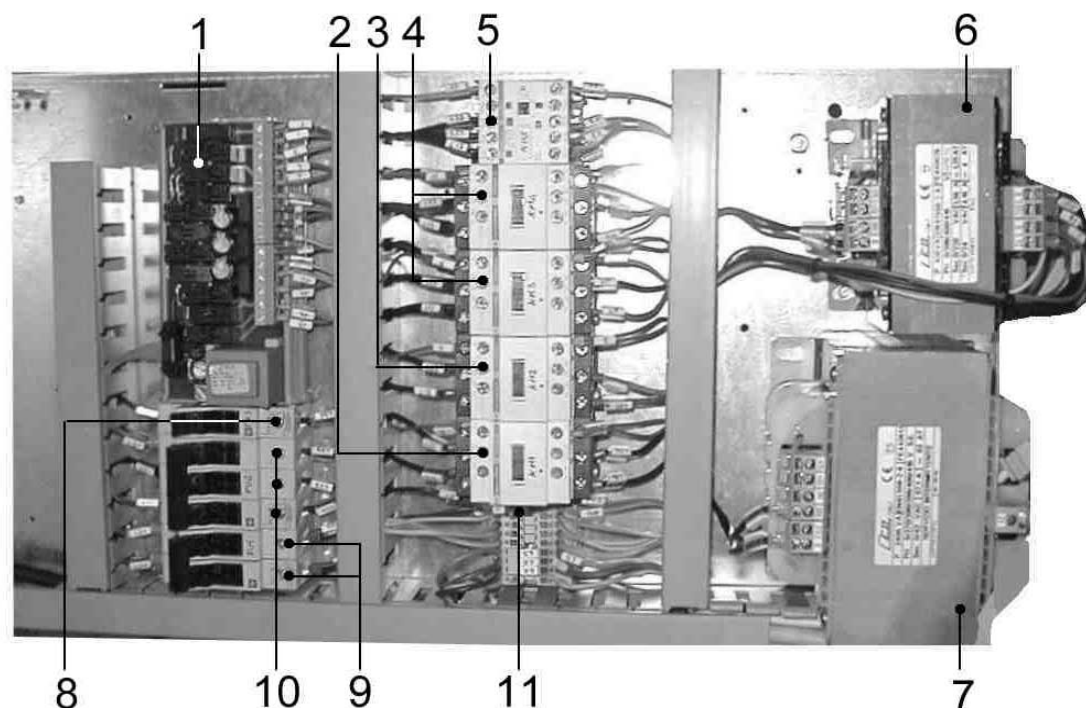

POS. POS.	CODICI PARTICOLARI ITEMS CODE	DENOMINAZIONI PARTICOLARI ITEMS DESCRIPTION	Q.tà Q.ty
1	FE120330	Modulo potenza / Power board	1
2	FE110615	Contattore LC1-D18B7 / Contactor LC1-D18B7	1
3	FE110602 FE110615	Contattore LC1-D09B7 (380/415V) / Contactor LC1-D09B7 (380/415V) Contattore LC1-D18B7 (200/208/220V) / Contactor LC1-D18B7 (200/208/220V)	1
4	FE110602	Contattore LC1-D09B7 / Contactor LC1-D09B7	2
5	FE110305	Contattore LP4-K0910BW3 / Contactor LP4-K0910BW3	1
6	FE440026 FE440025	Trasformatore 400VA (380/415V) / Transformer 400VA (380/415V) Trasformatore 400VA (200/208/220V) / Transformer 400VA (200/208/220V)	1
7	FE440613 FE440612	Trasformatore 2400VA (380/415V) / Transformer 2400VA (380/415V) Trasformatore 2400VA (200/208/220V) / Transformer 2400VA (200/208/220V)	1
8	FE290400 FE290401	Fusibile 10.3X38 1A (380/415V) / Fuse 10.3X38 1A (380/415V) Fusibile 10.3X38 2A (200/208/220V) / Fuse 10.3X38 2A (200/208/220V)	1
9	FE290407 FE290408	Fusibile 10.3X38 16A (380/415V) / Fuse 10.3X38 16A (380/415V) Fusibile 10.3X38 20A (200/208/220V) / Fuse 10.3X38 20A (200/208/220V)	2
10	FE290401 FE290402	Fusibile 10.3X38 2A (380/415V) / Fuse 10.3X38 2A (380/415V) Fusibile 10.3X38 4A (200/208/220V) / Fuse 10.3X38 4A (200/208/220V)	3
11	FE290117	Fusibile 5X20 T1A / Fuse 5X20 T1A	1

CASSETTO ELETTRICO MONOFASE
MONOPHASE WIRING BOX

TAVOLA 10.2
SCHEME 10.2

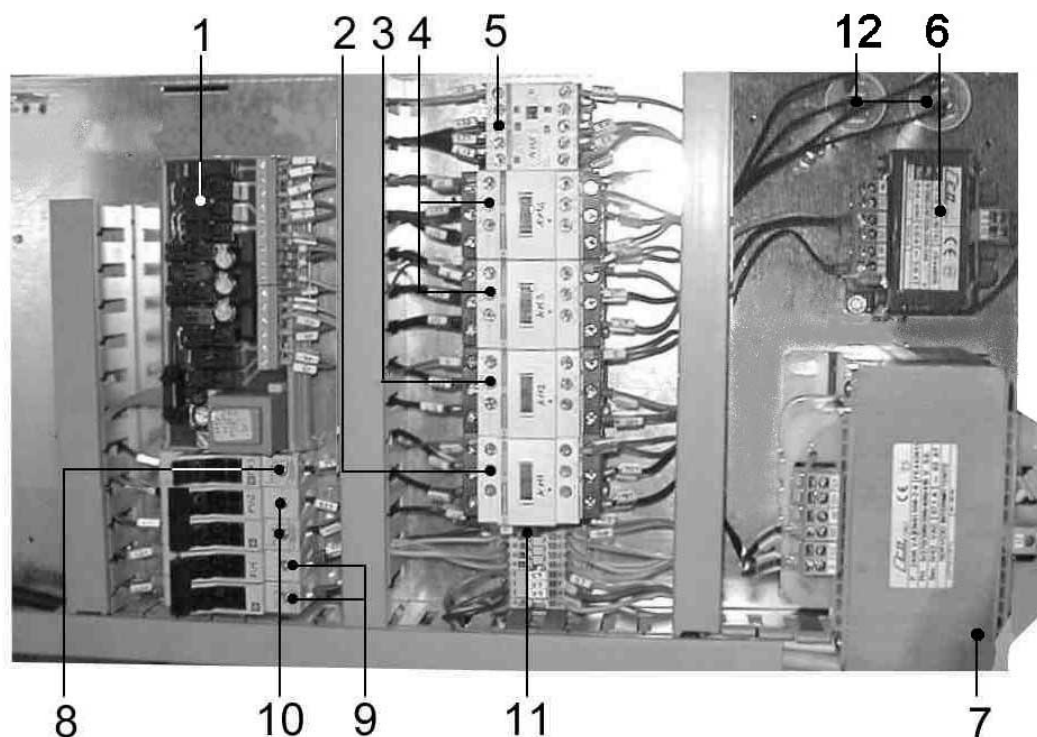

POS. POS.	CODICI PARTICOLARI ITEMS CODE	DENOMINAZIONI PARTICOLARI ITEMS DESCRIPTION	Q.tà Q.ty
1	FE120330	Modulo potenza / Power board	1
2	FE110615	Contattore LC1-D18B7 / Contactor LC1-D18B7	1
3	FE110615	Contattore LC1-D18B7 (200/208/220V) / Contactor LC1-D18B7 (200/208/220V)	1
4	FE110602	Contattore LC1-D09B7 / Contactor LC1-D09B7	2
5	FE110305	Contattore LP4-K0910BW3 / Contactor LP4-K0910BW3	1
6	FE440015	Trasformatore 75VA (200/208/220V) / Transformer 75VA (200/208/220V)	1
7	FE440612	Trasformatore 2400VA (200/208/220V) / Transformer 2400VA (200/208/220V)	1
8	FE290410	Fusibile 10.3X38 0,5A (200/208/220V) / Fuse 10.3X38 0,5A (200/208/220V)	1
9	FE290408	Fusibile 10.3X38 20A (200/208/220V) / Fuse 10.3X38 20A (200/208/220V)	2
10	FE290402	Fusibile 10.3X38 4A (200/208/220V) / Fuse 10.3X38 4A (200/208/220V)	2
11	FE290117	Fusibile 5X20 T1A / Fuse 5X20 T1A	1
12	FE088001	Condensatore mf8 V450 / Condenser mf8 V450	

SCHEMA ELETTRICO TRIFASE THREEPHASE WIRING DIAGRAM

TAVOLA 11.1 SCHEME 11.1

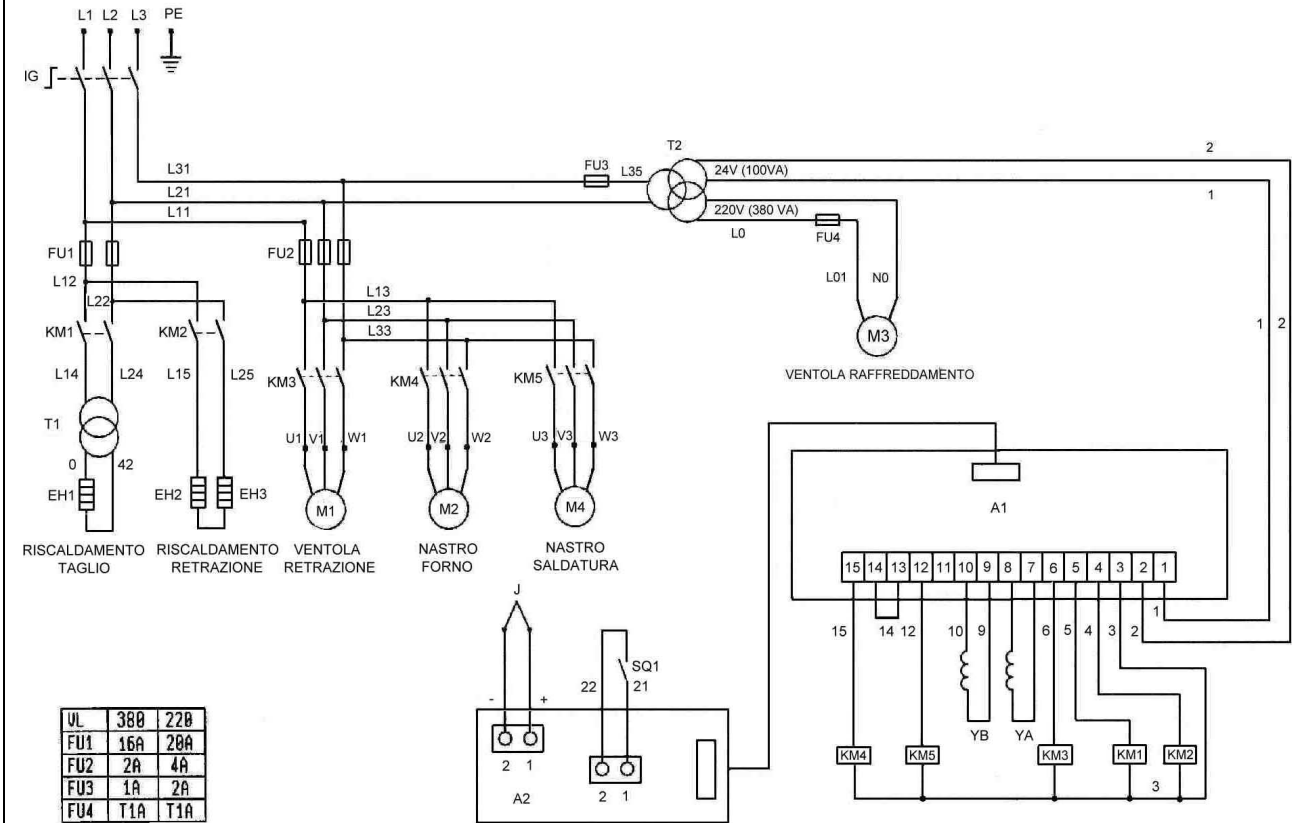

- IG Interruttore generale
- FU1 Fusibile generale saldatura / resistori
- FU2 Fusibile nastri / ventola retrazione
- FU3 Fusibile trasformatore ausiliario
- FU4 Fusibile motore ventola
- EH1 Resistenza lama saldatura
- EH2 Resistenza
- EH3 Resistenza
- T1 Trasformatore saldatura
- T2 Trasformatore ausiliari
- J Termocoppia
- SQ1 Micro start
- A1 Modulo potenza
- A2 Scheda comando
- KM1 Contattore lama saldatura
- KM2 Contattore resistenze
- KM3 Contattore motore ventola
- KM4 Contattore motore nastro forno
- KM5 Contattore motore nastro saldatura
- M1 Motore ventola retrazione
- M2 Motore nastro forno
- M3 Motore ventola raffreddamento
- M4 Motore nastro saldatura
- M5 Motore ventola x motore retrazione
- YA Elettromagnete retrazione
- YB Elettromagnete saldatura

- Main switch
- General fuse cutting / heater
- Oven tunnel / shrinking fan fuse
- Auxiliary transformer fuse
- Fan motor fuse
- Sealing blade heater
- Heater
- Heater
- Sealing transformer
- Auxiliary transformer
- Thermocouple
- Machine cycle limit switch
- Electronic control board
- Control board
- Sealing blade contactor
- Heaters contactor
- Fan motor contactor
- Oven belt motor contactor
- Motor contactor for sealing belt
- Shrinking fan motor
- Oven belt motor
- Fan motor of oven cooling
- Sealing belt motor
- Fan motor of shrinking motor
- Shrinking magnet
- Sealing magnet

SCHEMA ELETTRICO MONOFASE MONOPHASE WIRING DIAGRAM

TAVOLA 11.2 SCHEME 11.2

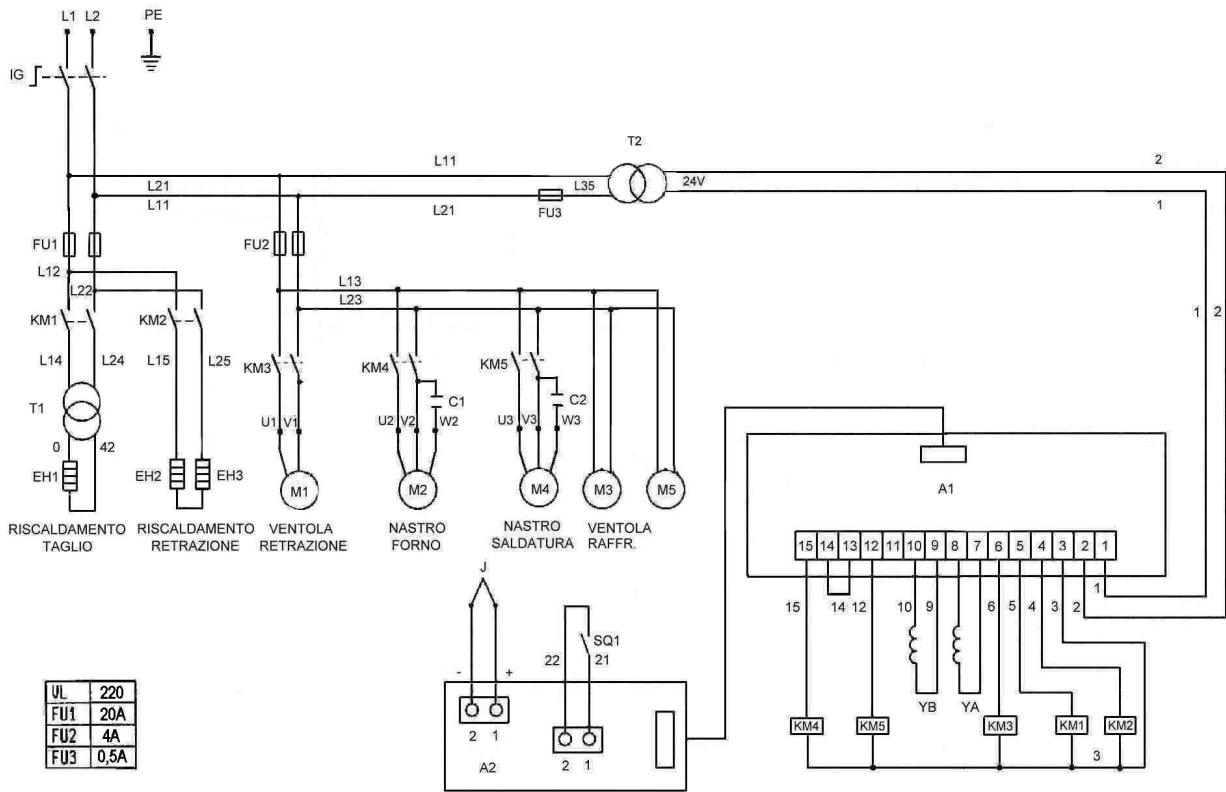

- | | | |
|-----|---|----------------------------------|
| IG | Interruttore generale | Main switch |
| FU1 | Fusibile generale saldatura / resistori | General fuse cutting / heater |
| FU2 | Fusibile nastri / ventola retrazione | Oven tunnel / shrinking fan fuse |
| FU3 | Fusibile trasformatore ausiliario | Auxiliary transformer fuse |
| FU4 | Fusibile motore ventola | Fan motor fuse |
| EH1 | Resistenza lama saldatura | Sealing blade heater |
| EH2 | Resistenza | Heater |
| EH3 | Resistenza | Heater |
| T1 | Trasformatore saldatura | Sealing transformer |
| T2 | Trasformatore ausiliari | Auxiliary transformer |
| J | Termocoppia | Thermocouple |
| SQ1 | Micro start | Machine cycle limit switch |
| A1 | Modulo potenza | Electronic control board |
| A2 | Scheda comando | Control board |
| KM1 | Contattore lama saldatura | Sealing blade contactor |
| KM2 | Contattore resistenze | Heaters contactor |
| KM3 | Contattore motore ventola | Fan motor contactor |
| KM4 | Contattore motore nastro forno | Oven belt motor contactor |
| KM5 | Contattore motore nastro saldatura | Motor contactor for sealing belt |
| M1 | Motore ventola retrazione | Shrinking fan motor |
| M2 | Motore nastro forno | Oven belt motor |
| M3 | Motore ventola raffreddamento | Fan motor of oven cooling |
| M4 | Motore nastro saldatura | Sealing belt motor |
| M5 | Motore ventola x motore retrazione | Fan motor of shrinking motor |
| YA | Elettromagnete retrazione | Shrinking magnet |
| YB | Elettromagnete saldatura | Sealing magnet |
| C1 | Condensatore x motore nastro forno | Condenser oven belt motor |
| C2 | Condensatore x motore nastro saldatura | Motor condenser for sealing belt |



Minipack-torre S.p.A.

Via Provinciale, 54 - 24044 DALMINE (BG) - ITALY

Tel. (035) 563525 – Fax (035) 564945

E-mail: info@minipack-torre.it

Internet: www.minipack-torre.it